

IP67

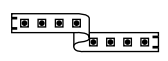

OPAL

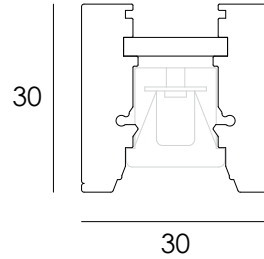

ARCS AVAILABLE IN CUSTOM ANGLES AND RADII

RADIUS IN HORIZONTAL PLANE ONLY (I.E. LENS IS DOWN)
RADIUS NOT AVAILABLE IN VERTICAL PLANE

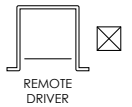
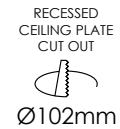
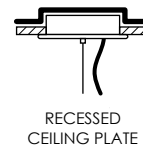

DESIGN FEATURES

- Curves available in custom sizes to suit project requirements
- Utilises silicone Neon LED
- In-house Neon LED length customisation
- In-house Neon LED moulded end caps
- IP67 ingress protection
- Dot free homogeneous illumination
- Dust free matt finish silicone
- Multiple fixed output options
- Up to 92 exit lumens per system watt
- 90+ colour rendering
- 10m max single length of LED with single power feed (White)
- 5m max single length of LED with single power feed (TW / RGB/W)
- Max single length doubles with dual power feed option

- UV protected
- Screwless end caps
- Complies with AS/NZS 60598.2.1
- 50,000 hrs lifetime
- L70B50 > 50,000 hrs
- 3 year warranty
- Project specific labelling referencing type numbers
- Detailed shop drawings
- Miter joints are not available

LUMEN PERFORMANCE

T1616 NEON LED

20.1 W p/mtr 1584 lm p/mtr

SYSTEM WATTAGE & EXIT LUMENS
TESTED WITH WHITE FINISH AT 4000K

OPTIONS

- INT FINISH:** White / Black / Silver / Gold / Custom
EXT FINISH: White / Black / Silver / Gold / Custom
CEILING PLATE FINISH: White / Black
CEILING PLATE TYPE: Surface Mounted / Recessed
SUSPENSION TYPE: 2m Wire / 4m Wire
COLOUR TEMP: 2700K / 3000K / 4000K / TW / RGB / RGBW
DRIVER: Non Dim / DALI Dim / DMX