

TRIM & TRIM SOFT

RECESSED PROFILE

DARKON™
THE EDGE OF LIGHT

Ensure that products are mounted with supplied, recommended or appropriate screws and fixings to suit the mounting surface.

WARNING

INSTALLATION IS ONLY TO BE CARRIED OUT BY SUITABLY QUALIFIED PERSONS IN ACCORDANCE WITH INSTALLATION INSTRUCTIONS AND ALL APPLICABLE REGULATIONS OR STANDARDS. (IMPROPER INSTALLATION CAN CREATE AN ELECTRICAL HAZARD WITH RISK OF ELECTRIC SHOCK, FIRE OR INJURY). DARKON WILL NOT BE HELD RESPONSIBLE FOR ANY CONSEQUENCES ARISING FROM IMPROPER PRODUCT HANDLING, STORAGE OR INSTALLATION.

TOOLS REQUIRED

POWER DRILL / DRILL BIT / PHILLIPS DRIVER / PENCIL / SCREWDRIVER
WALLBOARD SAW / LENS REMOVAL TOOL

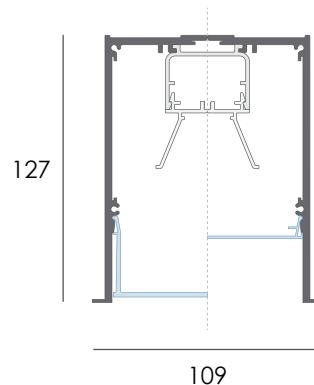
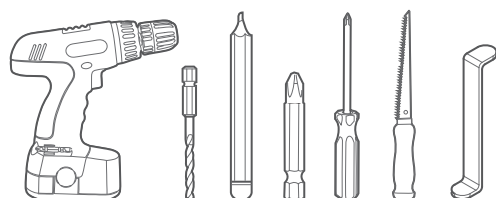

REC LENS

FLUSH LENS

SOFT ENDCAP

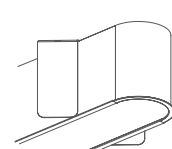
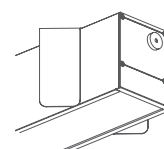
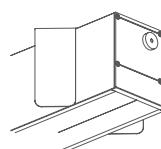

160

182

COMPONENTS

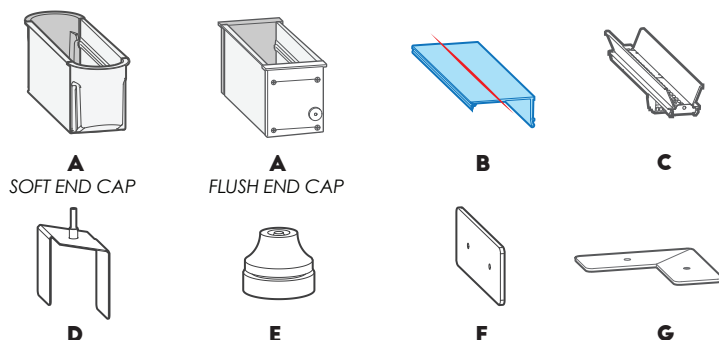

MAINTENANCE



Wipe product with a clean dry microfiber cloth.
Do not use any cleaning products/ chemicals to clean product.

SERVICING

-Lens can be removed w/ suction cups or lens removal tool.
-'Light Tray' can be replaced if deemed faulty

MINIMUM AREA REQUIREMENTS

FIGURE 1.
POWERFEED DIMENSIONS ONLY
APPLICABLE FOR FLUSH END CAP

FOR OPTIMAL LONGEVITY,
ENSURE UNRESTRICTED AIRFLOW
OVER LUMINAIRE HEATSINK
DO NOT COVER W/ INSULATION
CUT OUT



LENGTH LESS
14mm x 100mm W

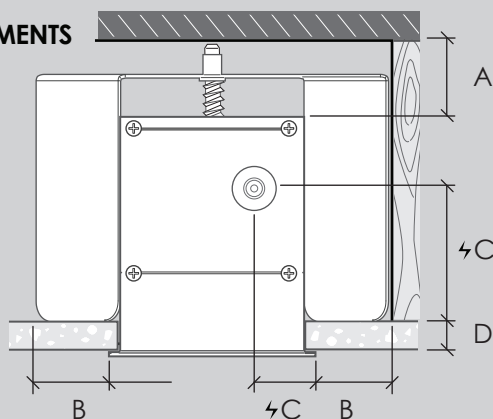

	DISTANCE	DESCRIPTION
A)	40MM	CLEARANCE FOR TOP OF LUMINAIRE
B)	50MM	CLEARANCE B/W STRUCTURAL MEMBER
C)	100MM H 35MM W	POWERFEED LOCATION
D)	20MM	MAXIMUM WALL BOARD THICKNESS

IP22



TRIDONIC LLE LED

10.11.21

PAGE: 1/3

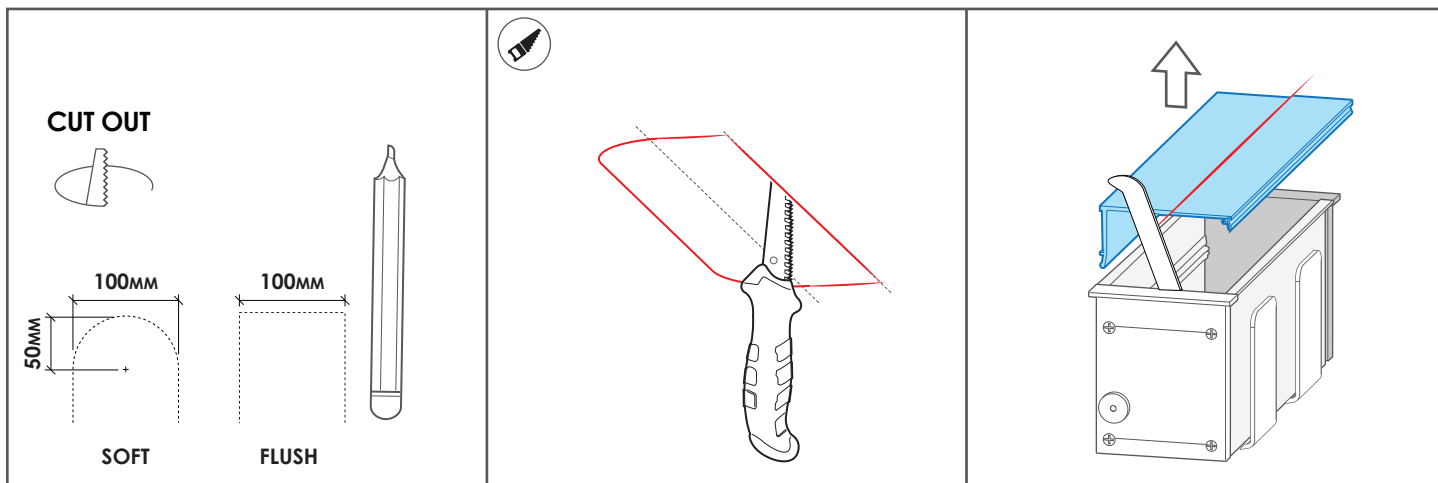

1.
Measure and mark the appropriate cut out for where the fitting is to be installed.
*refer to supplied shop drawings.

2.
-Make the cut-out using a Wallboard Saw(or appropriate tool).

3.
-Remove the Lens(B) using lens removal tool to lever out of clipping detail.

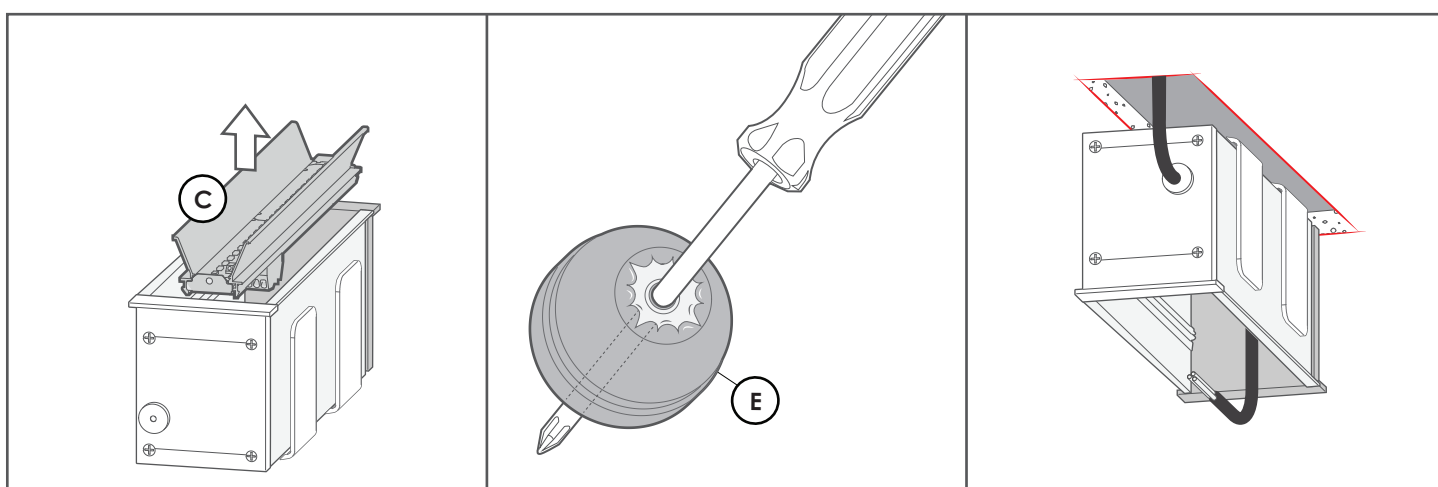

4.
-Remove the Light tray(C) using a Flat head screw driver to lever the tray out from the clips.

4.
-Pierce the IP Grommet(E) with the tip of a screw driver.

5.
-Feed the Power Cable through the pierced IP Grommet & insert the mainbody into the cut out.

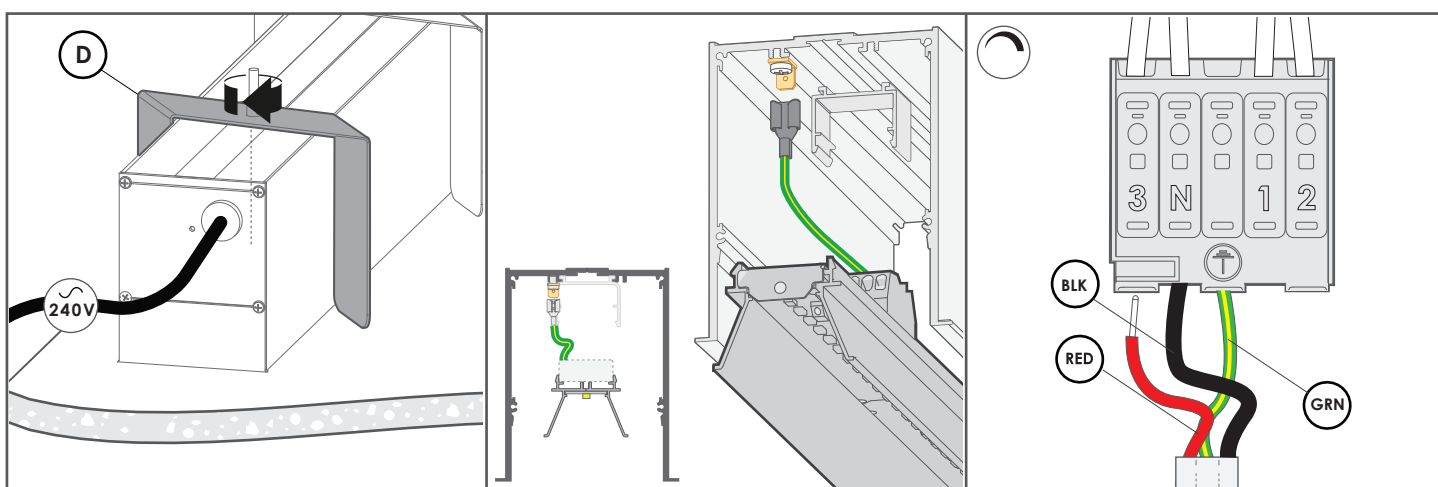

6.
-With a Screwdriver; screw the bolt in order to re-orienate the Spring Clip(D) to suspend the light fixture.

7.
-Bolt Earth lug to recessbody(A).

8A. IF NON DIM
-Wire primary wires into terminal.

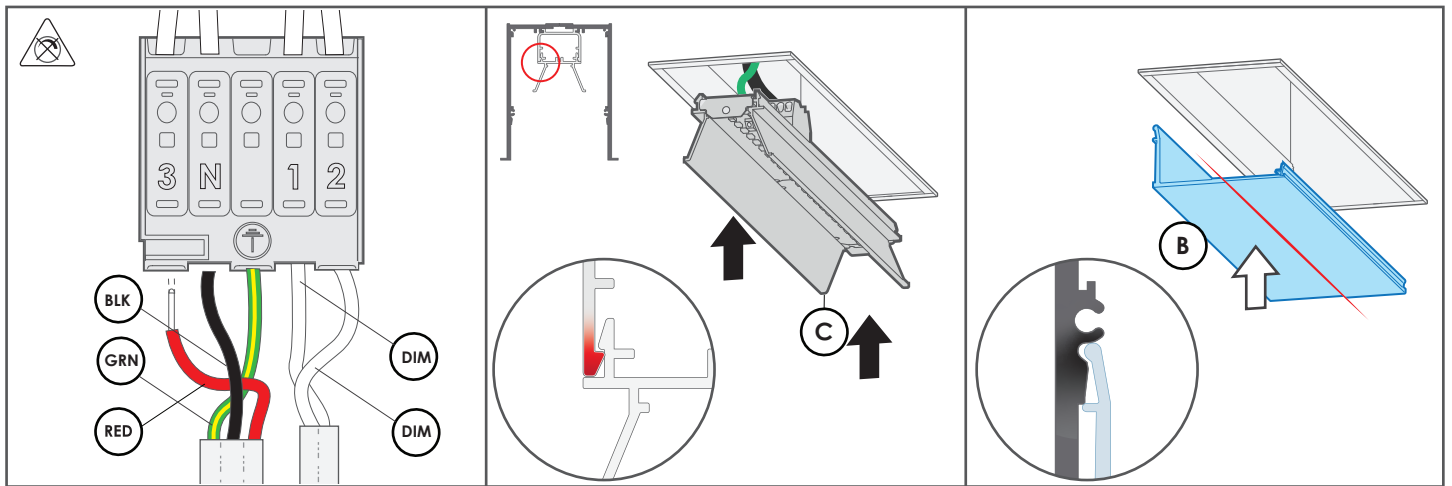

8B. IF DIM

- Wire primary wires into terminal.
- Wire Dimming wires into terminal.

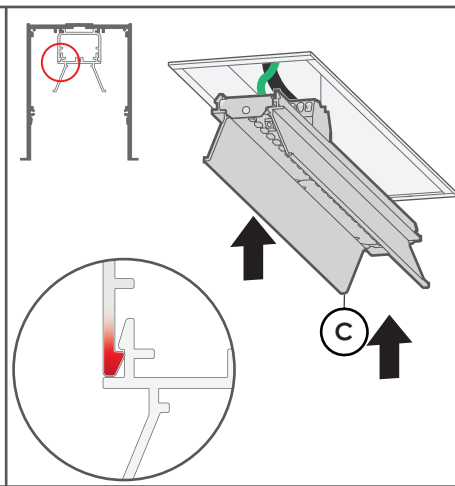

9.

- Install Light Tray into clips(H)

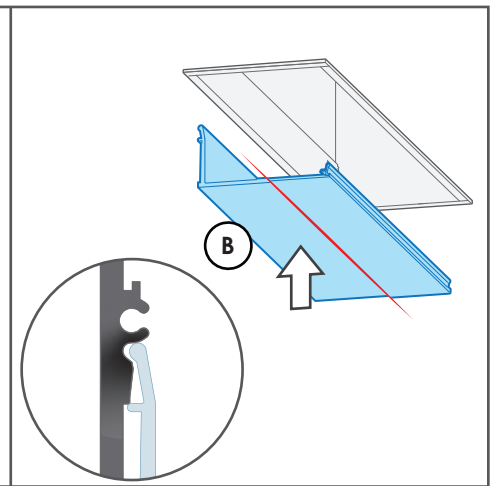

10.

- Install Lens (B) by inserting into clipping detail.

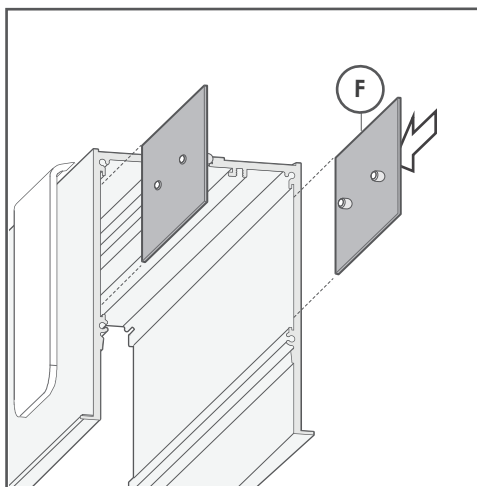

11. IF MULTIPLE BODIES

- Replicate stage 1-11 by installing first recessed body.
- Slide linear connectors into the sliding detail of the second recessbody(A).

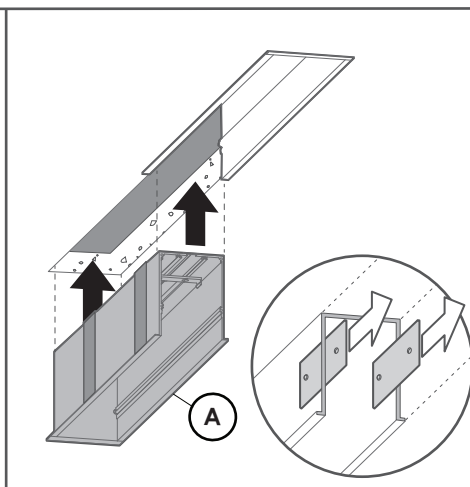

12.

- Insert second recess body. Slide linear connectors into the sliding detail of the recessbody(A). Ensure connector is overlapping join.

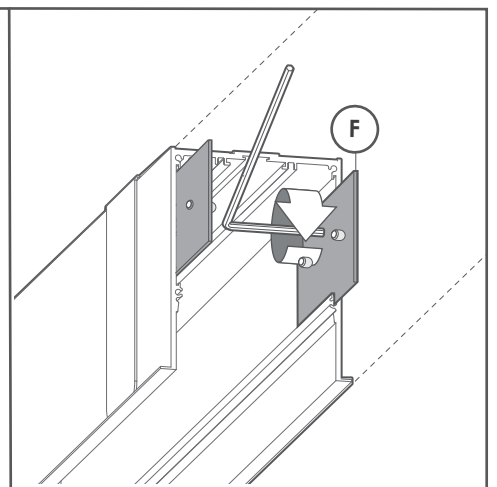

13.

- Tighten all grub screws to lock linear connectors(F) in place with 3mm allen key.

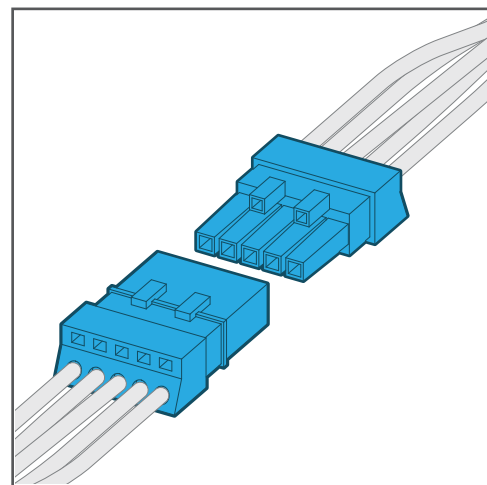

14.

- Connect the appropriate plugs.

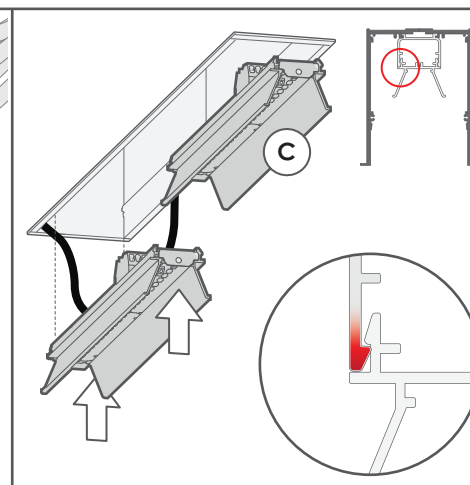

15.

- Install Light Tray(C) by inserting into light tray clips. Centre light trays to ensure homogenous illumination.

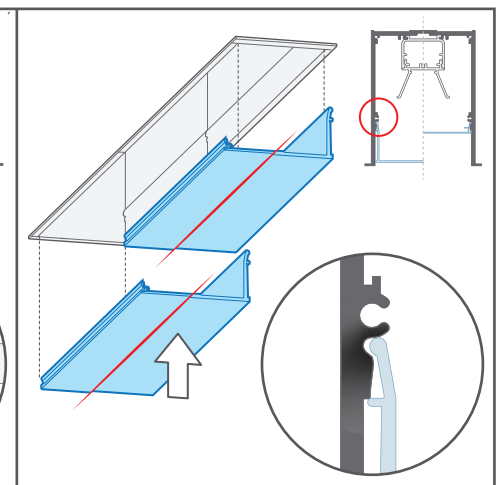

18.

- Install Lens (B) by inserting into recessbody(A) clipping detail.

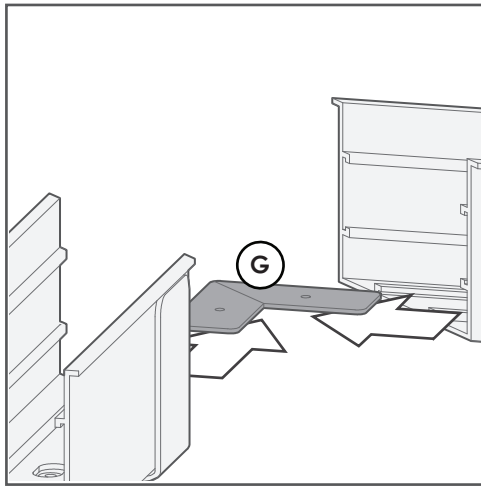

19. IF MITRED CORNER

-Replicate stage 1-11 by installing first recessed body. Slide mitre bracket(G) into sliding detail of mitred bodies(A)

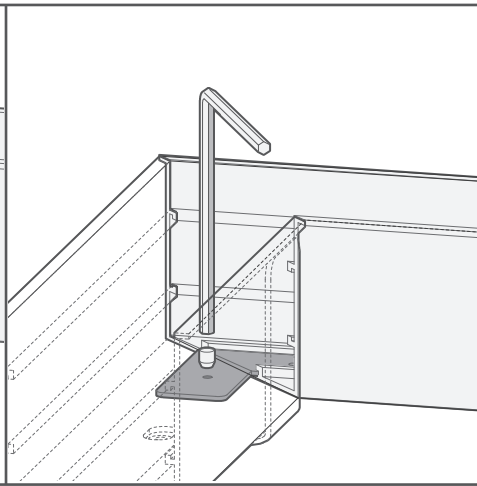

20.

-Tighten all grub screws to lock mitre bRacket(G) in place with 3mm allen key.

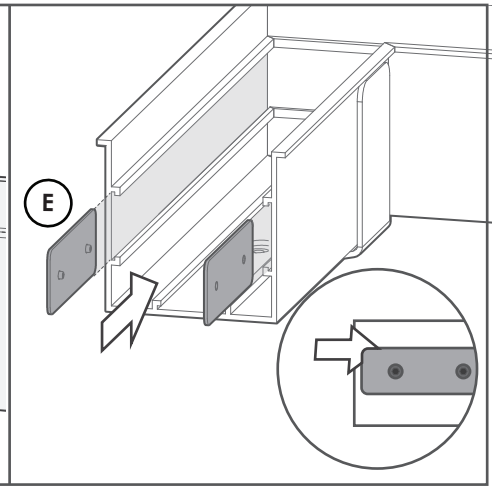

21. IF SYSTEM

-Slide linear connectors into the sliding detail of the recessbody(A).

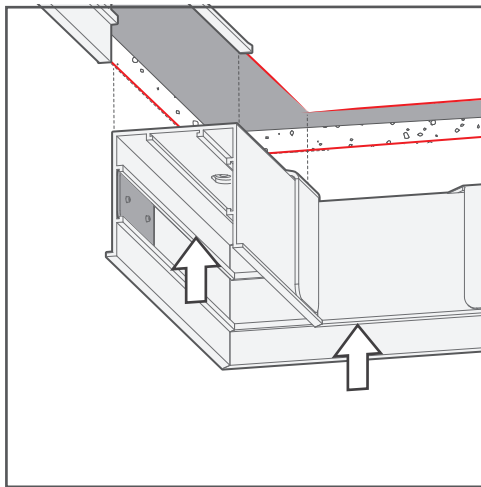

22.

-Insert fixed recess body into cutout.

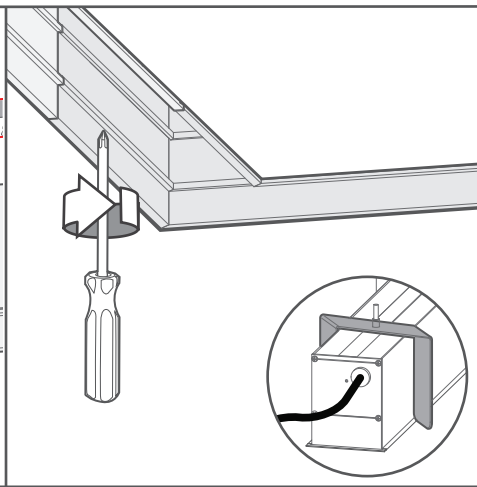

23.

-With a Screwdriver; screw the bolt in order to re-orientate the Spring Clip(D) to suspend the light fixture.

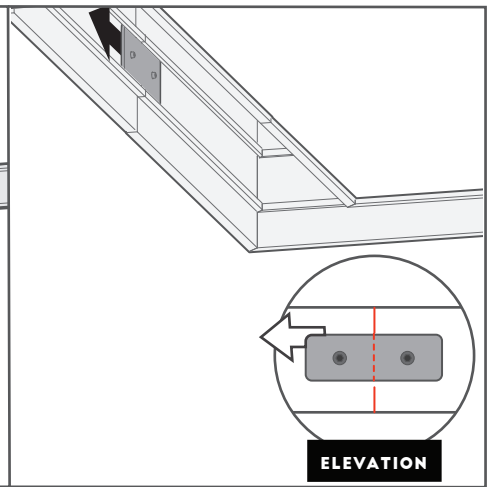

24.

-Slide linear connectors into the sliding detail of the recessbody(A). Ensure connector is overlapping join.

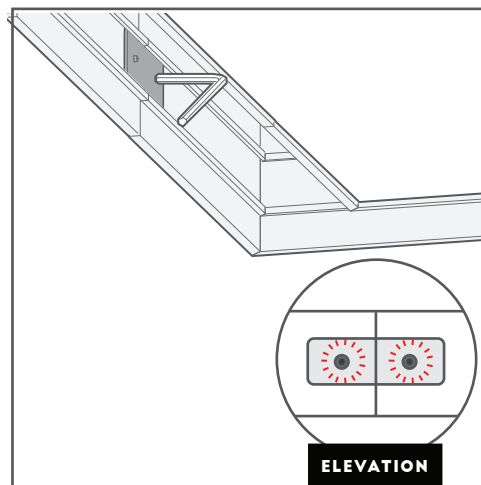

25.

-Tighten all grub screws to lock linear connectors(F) in place with 3mm allen key.

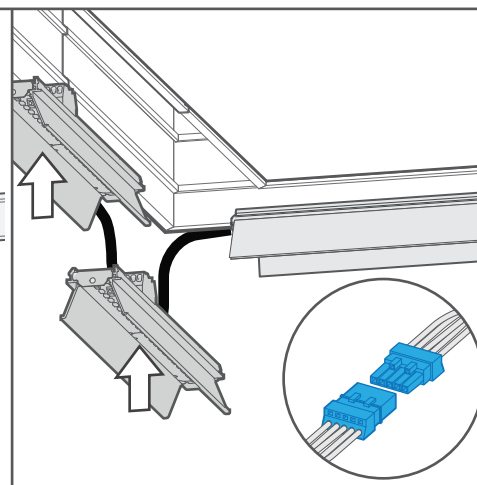

26.

-Connect the appropriate plugs. Install Light Tray(C) by inserting into light tray clips. Centre light trays to ensure homogenous illumination.

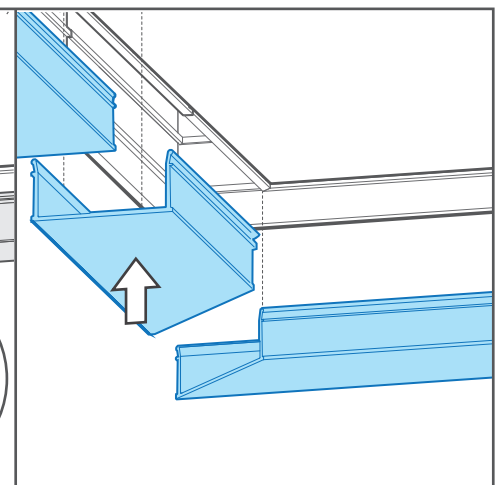

27.

-Install Lens (B) by inserting into recessbody(A) clipping detail.