

SLIM C WALL MK4

WALL MOUNTED PROFILE

DARKON™
THE EDGE OF LIGHT

Ensure that products are mounted with supplied, recommended or appropriate screws and fixings to suit the mounting surface.

WARNING

INSTALLATION IS ONLY TO BE CARRIED OUT BY SUITABLY QUALIFIED PERSONS IN ACCORDANCE WITH INSTALLATION INSTRUCTIONS AND ALL APPLICABLE REGULATIONS OR STANDARDS. (IMPROPER INSTALLATION CAN CREATE AN ELECTRICAL HAZARD WITH RISK OF ELECTRIC SHOCK, FIRE OR INJURY). DARKON WILL NOT BE HELD RESPONSIBLE FOR ANY CONSEQUENCES ARISING FROM IMPROPER PRODUCT HANDLING, STORAGE OR INSTALLATION.

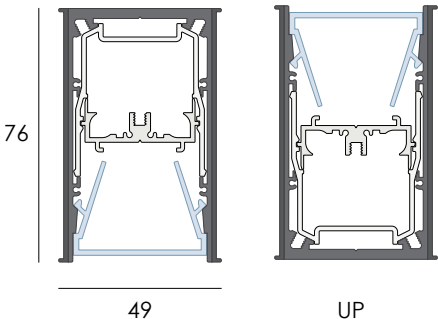

TOOLS REQUIRED

POWER DRILL / DRILL BIT / PHILLIPS DRIVER / PENCIL / SCREWDRIVER / LENS REMOVAL TOOL

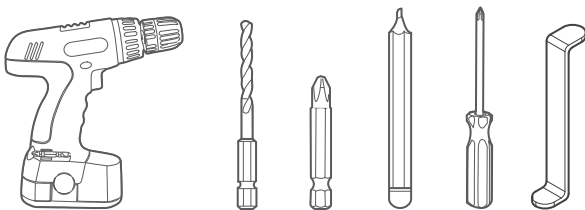

MAINTENANCE

Wipe product with a clean dry microfiber cloth. Do not use any cleaning products / chemicals to clean product.



SERVICING

'Driver' can be replaced if deemed faulty.

COMPONENTS

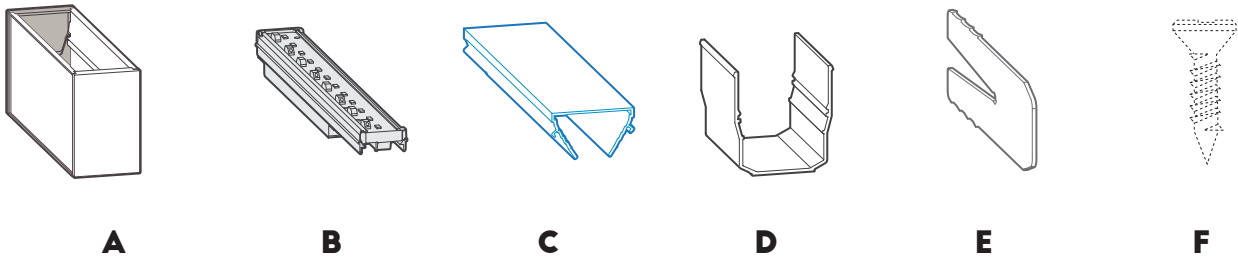

ORIENTATION	DISTANCE		DESCRIPTION
	DOWN	UP	
A)	155 HORIZ 44 VERTICAL	155 HORIZ 42 VERTICAL	MOUNTING POINT
B)	PROFILE LENGTH ÷ 2 (HORIZ) 44 VERTICAL	42 VERTICAL	3RD MOUNTING LOCATION (IF LENGTH IS GREATER THAN 2.2M)
C)	50 HORIZ. 20 VERTICAL		POWERFEED LOCATION

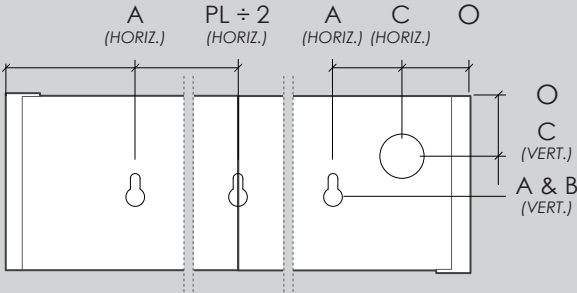
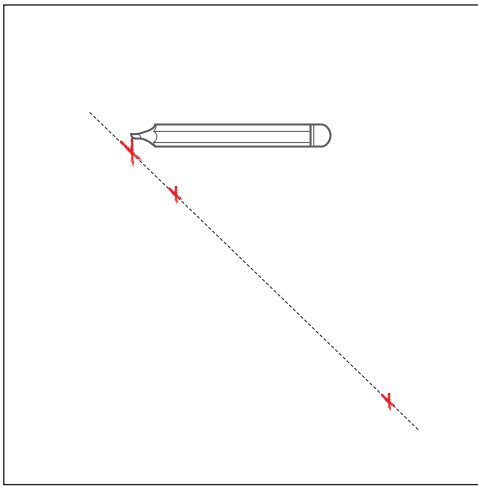
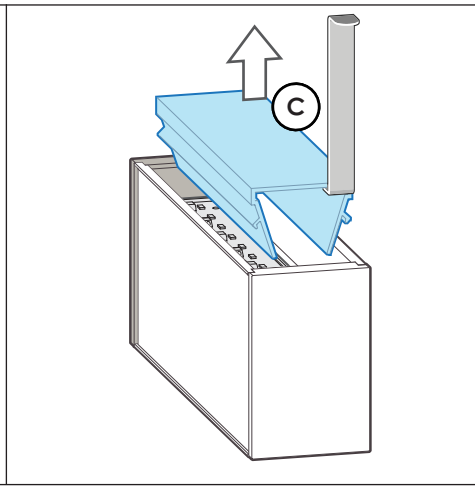

FIGURE 1. CRITICAL DIMENSIONS





1.
Measure and mark the appropriate placement of luminaire.
Refer to **FIGURE 1** for critical dimensions.



2.
Use 'Lens Tool' to lever *Lens(C)* out of clipping detail.

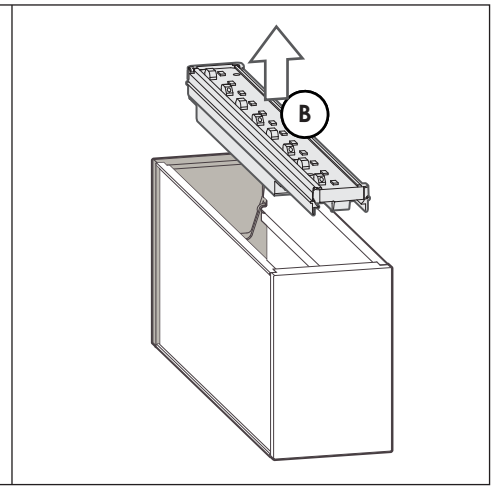

3.
Remove *Light Tray(B)* using a flat screw driver to lever out of clips.

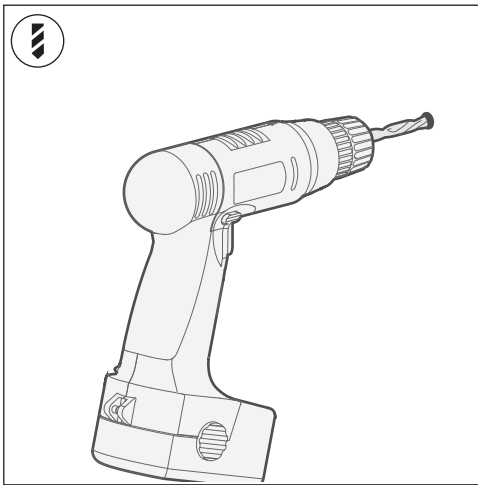

4.
Drill all necessary holes with an appropriate drill bit.

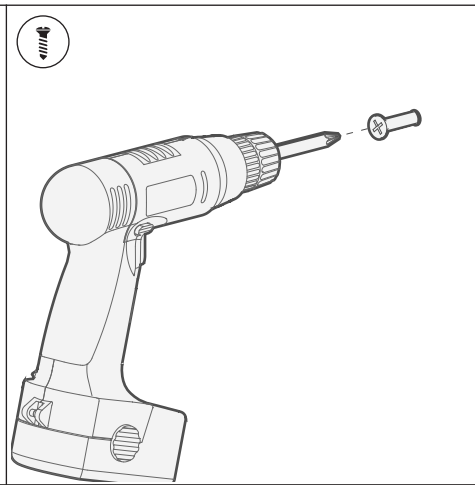

5.
Screw appropriate fasteners onto wall. Ensure screw head sits proud of wall.

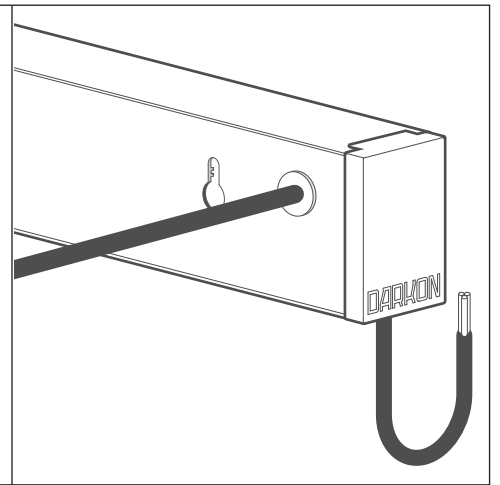

6.
Feed the Power Cable through Grommet found at start of *Mainbody(A)*.

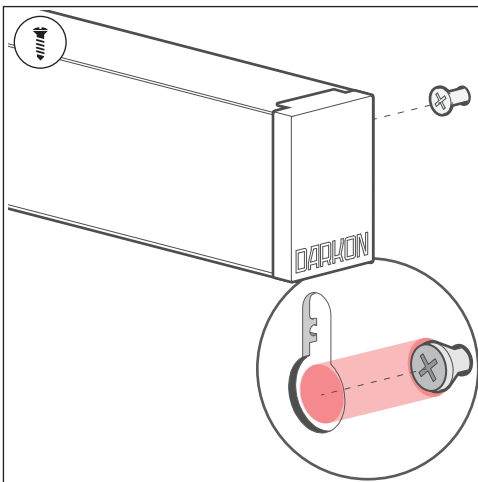

7.
Align & Insert keyholes of *Mainbody(A)* into the screw head.

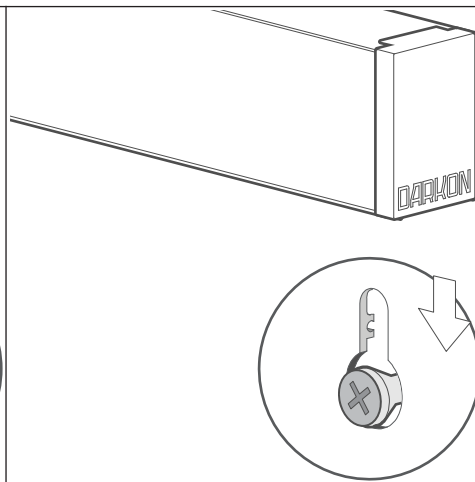

8.
Slightly pull fitting down.

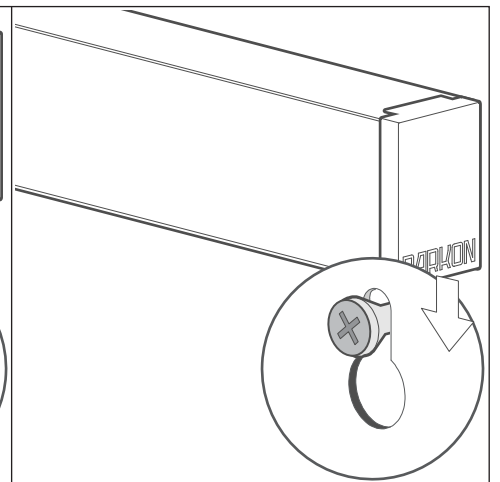

9.
Ensure all screw heads are retained by the narrower portion of the keyhole.

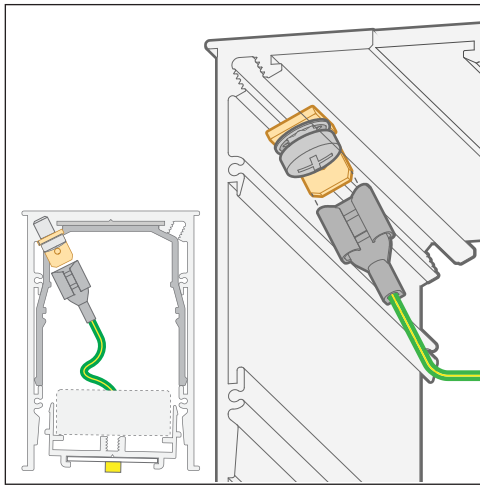

10.
Insert Earth spade into Terminal located at the start of *Mainbody(A)*.

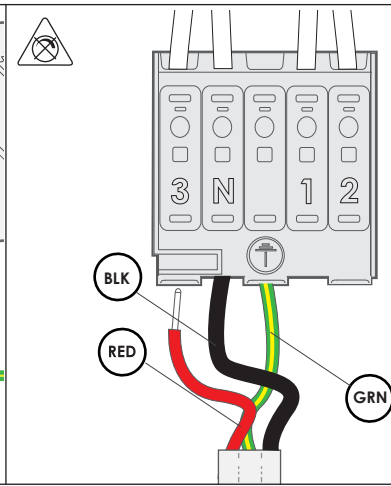

11A. IF NON DIM
Wire primary wires into terminal.

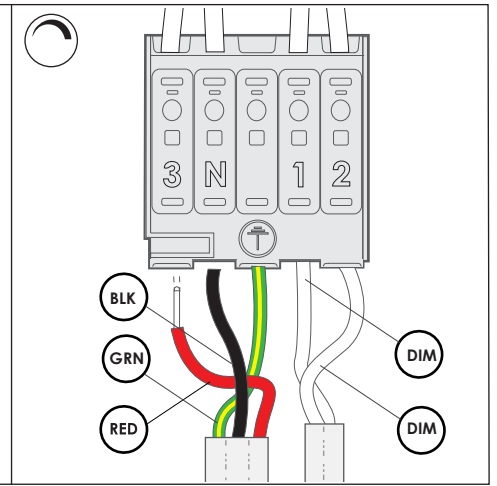

11B. IF DIM
Wire primary wires into terminal.
Wire dimming wires into terminal.

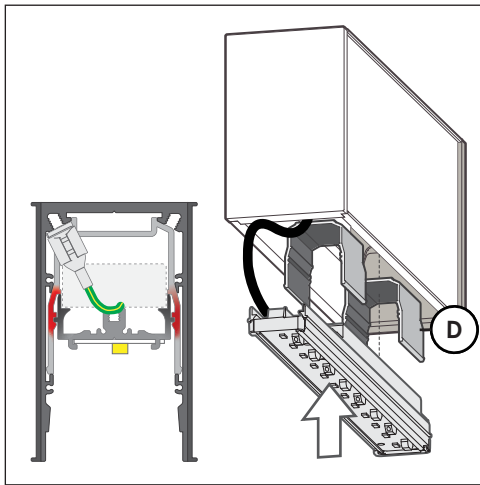

12.
Install *Light Tray(B)* by snap fitting into *Light Tray Clips(D)*. Centre light tray.

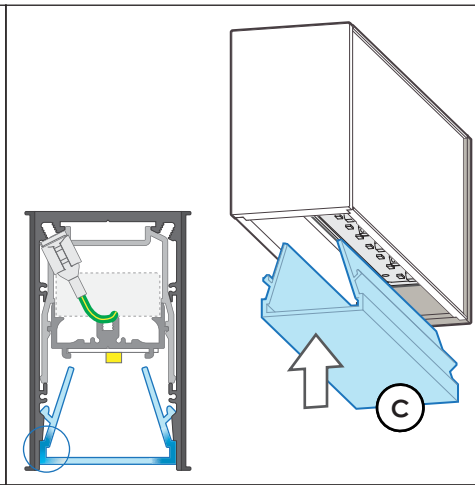

13.
Install *Lens(B)* by snap fitting into clipping detail. Centre lens.

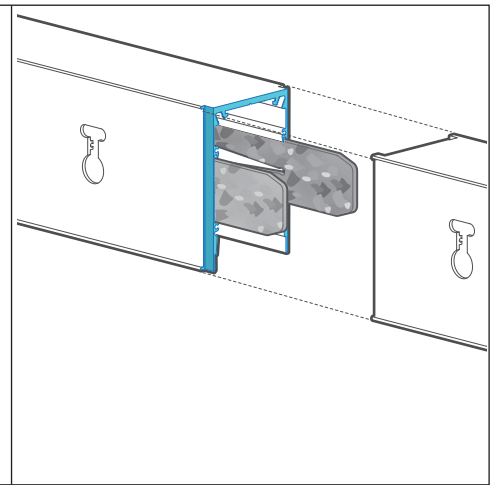

14. IF MULTIPLE BODIES
Replicate steps 1-6 in screwing fasteners to wall. Align *Linear Connectors(E)* in sliding detail of *Mainbody(A)* with 'START' body.

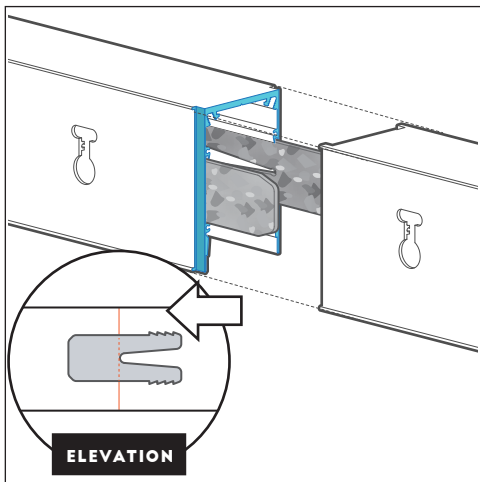

15.
Push male 'END' body into female 'START' body.

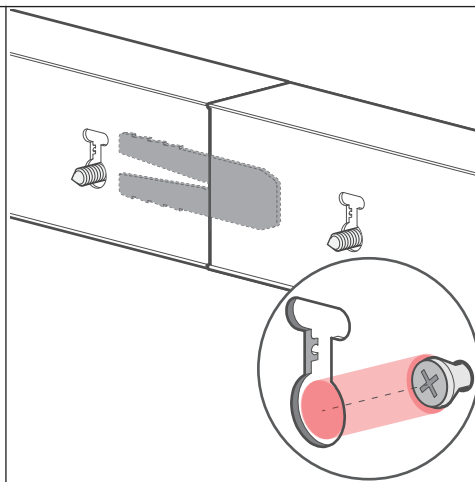

16.
Align & Insert keyholes of *Mainbody(A)* into the screw head.

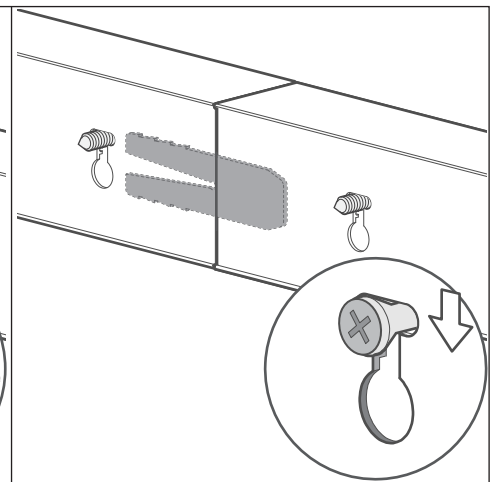

17.
Slightly pull fitting down. Ensure all screw heads are retained by the narrower portion of the keyhole.

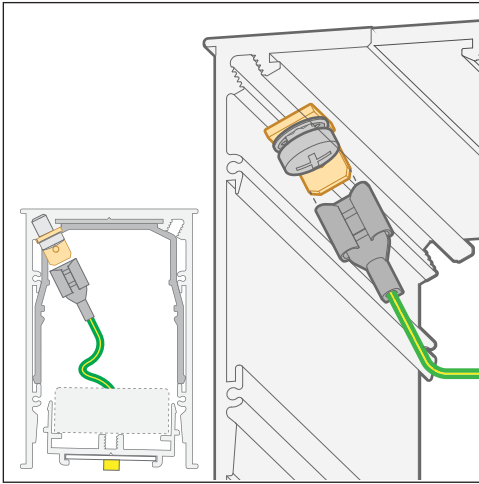

18.
Insert Earth spade into Terminal on all bodies.

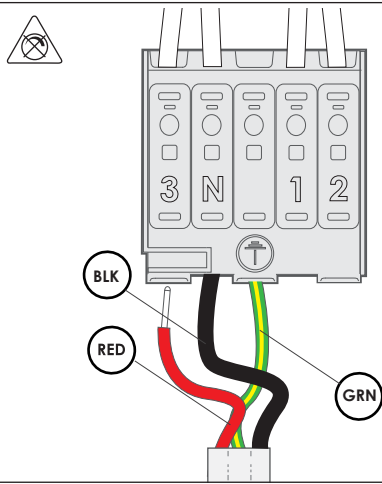

19A. IF NON DIM
Wire primary wires into terminal.

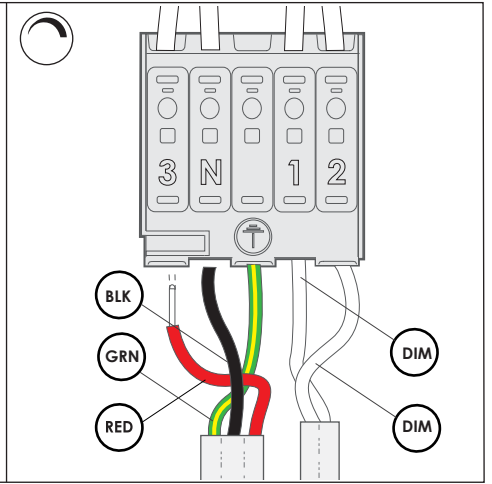

19A. IF DIM
Wire primary wires into terminal.
Wire Dimming wires into terminal.

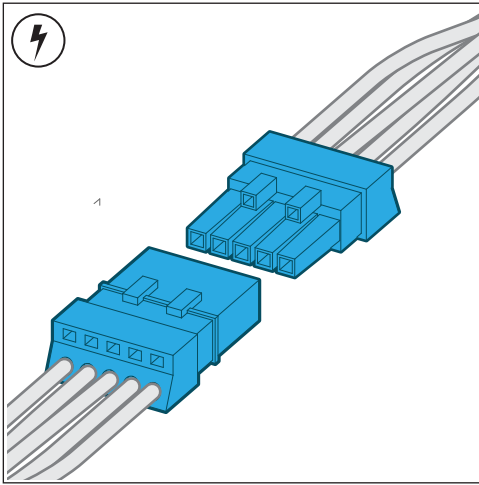

20.
Connect the appropriate plugs.

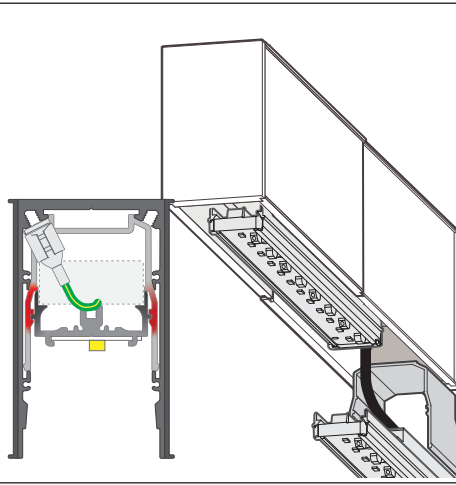

21.
Install *Light Tray(B)* by snap fitting into *Light Tray Clips(D)*. Centre light tray.

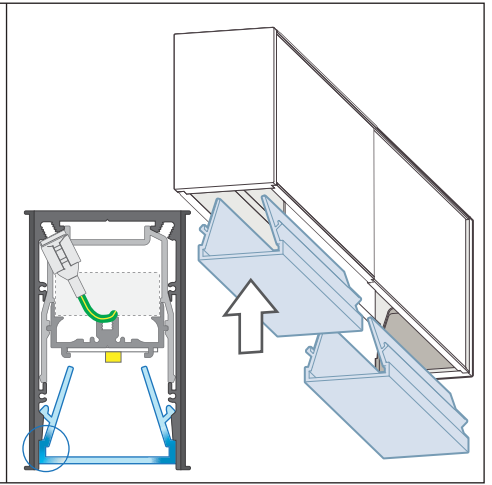

22.
Install *Lens(B)* by snap fitting into clipping detail. Centre lens.