

SLIM C SUS MK4

SUSPENDED PROFILE

DARKON™
THE EDGE OF LIGHT

Ensure that products are mounted with supplied, recommended or appropriate screws and fixings to suit the mounting surface.

WARNING

INSTALLATION IS ONLY TO BE CARRIED OUT BY SUITABLY QUALIFIED PERSONS IN ACCORDANCE WITH INSTALLATION INSTRUCTIONS AND ALL APPLICABLE REGULATIONS OR STANDARDS. (IMPROPER INSTALLATION CAN CREATE AN ELECTRICAL HAZARD WITH RISK OF ELECTRIC SHOCK, FIRE OR INJURY). DARKON WILL NOT BE HELD RESPONSIBLE FOR ANY CONSEQUENCES ARISING FROM IMPROPER PRODUCT HANDLING, STORAGE OR INSTALLATION.

TOOLS REQUIRED

POWER DRILL / DRILL BIT / PHILLIPS DRIVER / PENCIL / PLIERS / TAPE MEASURE / PLUM LASER.

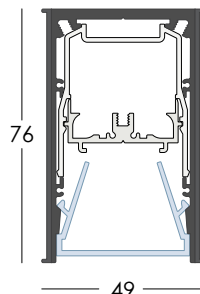
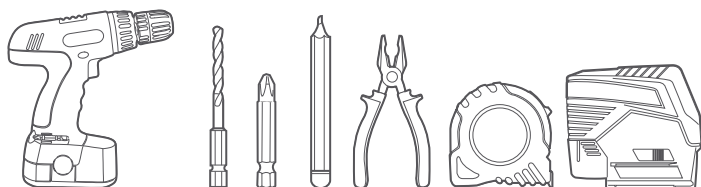

NOTE

Only multi body fittings are supplied with components K, L, M.

MAINTENANCE

Wipe product with a clean dry microfiber cloth. Do not use any cleaning products / chemicals to clean product.



SERVICING

'Driver' can be replaced if deemed faulty.

COMPONENTS

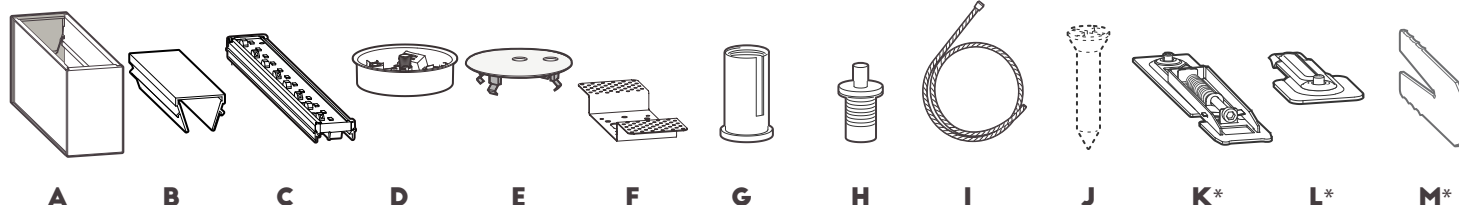

REC

CUT OUT



Ø100

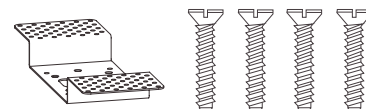

SUPPLIED IF REC CEILING PLATE

SUSPENSION DIMENSIONS

FIGURE 1.

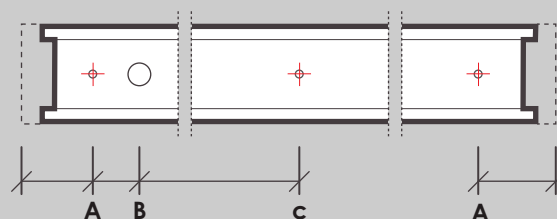

DISTANCE

DESCRIPTION

| | | |
|----|--------------------|---|
| A) | 25MM | SUSPENSION LOCATION |
| B) | 55MM | POWERFEED LOCATION |
| C) | PROFILE LENGTH ÷ 2 | 3RD MOUNTING LOCATION (IF LENGTH IS GREATER THAN 2.2M) |

IP22



07.03.22

www.darkon.com.au

REVISION 02

1/5

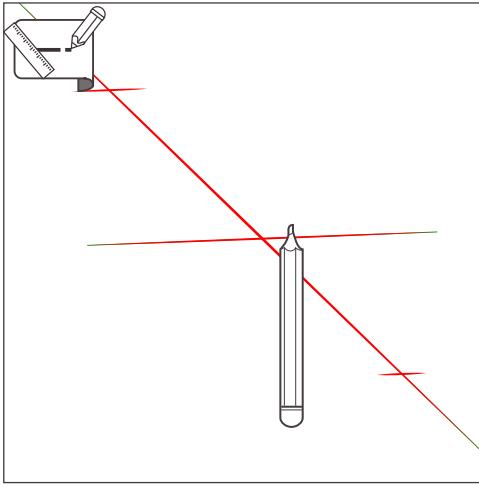

1.
Project line using laser plumb and mark necessary mounting points using supplied Darkon drawing as reference.

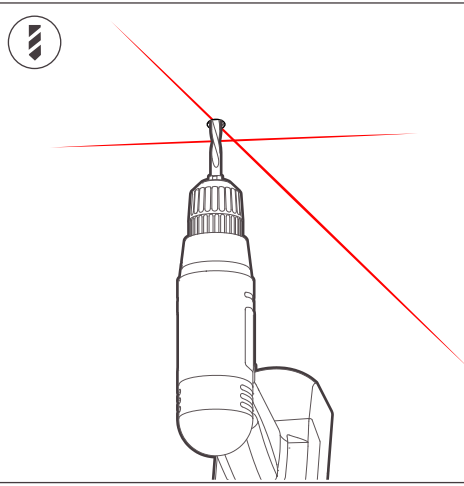

2A IF SM CEILING PLATE
Drill hole for power feed, drill pilot holes if necessary.

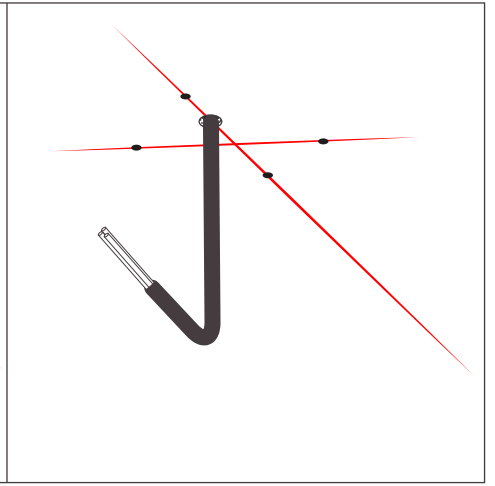

3A IF SM CEILING PLATE
Pull power cable (240V) through ceiling.

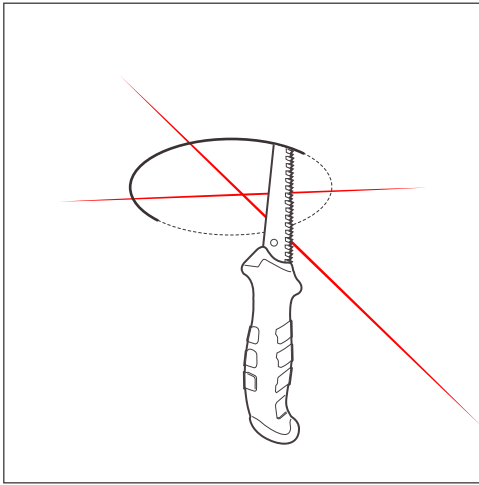

3B.1 IF REC CEILING PLATE
Make cutout using appropriate wallboard saw.

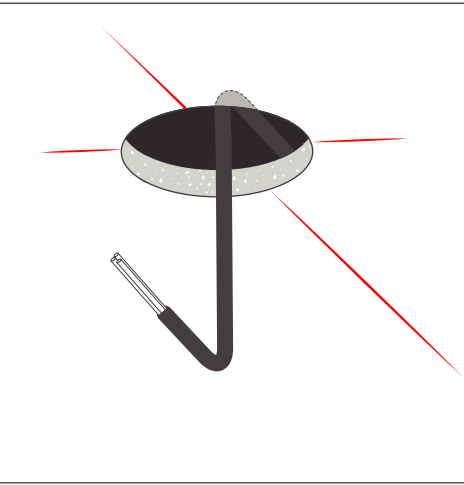

3B.3 IF REC CEILING PLATE
Pull power cable (240V) through cutout.

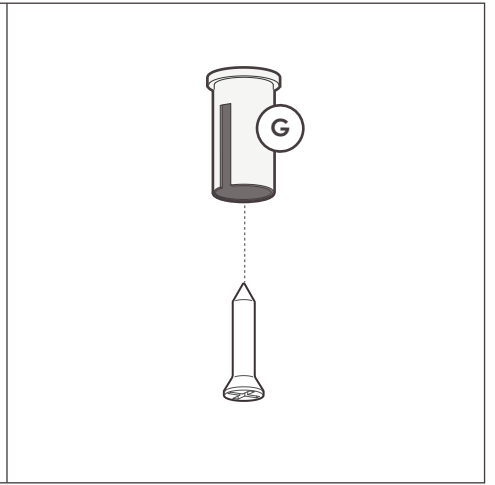

4.
Fix remaining Posilock(G) onto the ceiling with appropriate fasteners (not supplied).

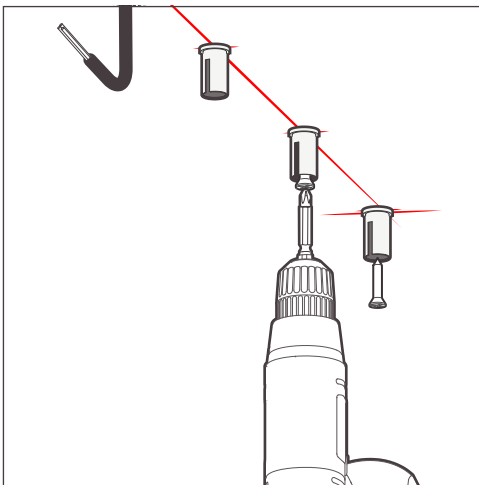

4B. IF MULTIPLE BODIES
Fix Posilocks(G) of multibodies onto ceiling with appropriate fasteners (not supplied).

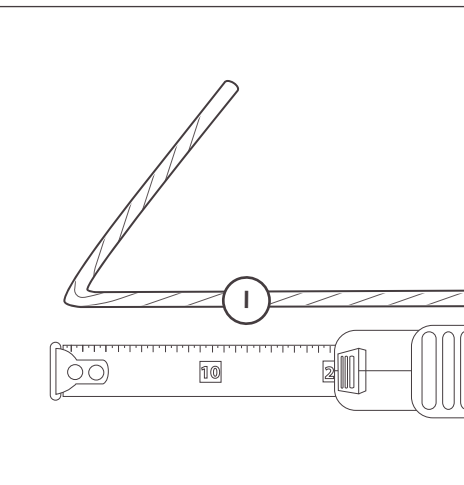

5.
Measure desired length of the Suspension wire(I). Lightly bend and crimp to mark desired length.

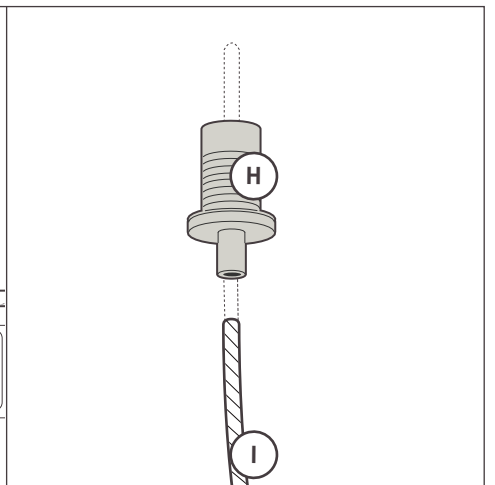

6.
Thread the Suspension wire(I) through Wire Gripper(H).

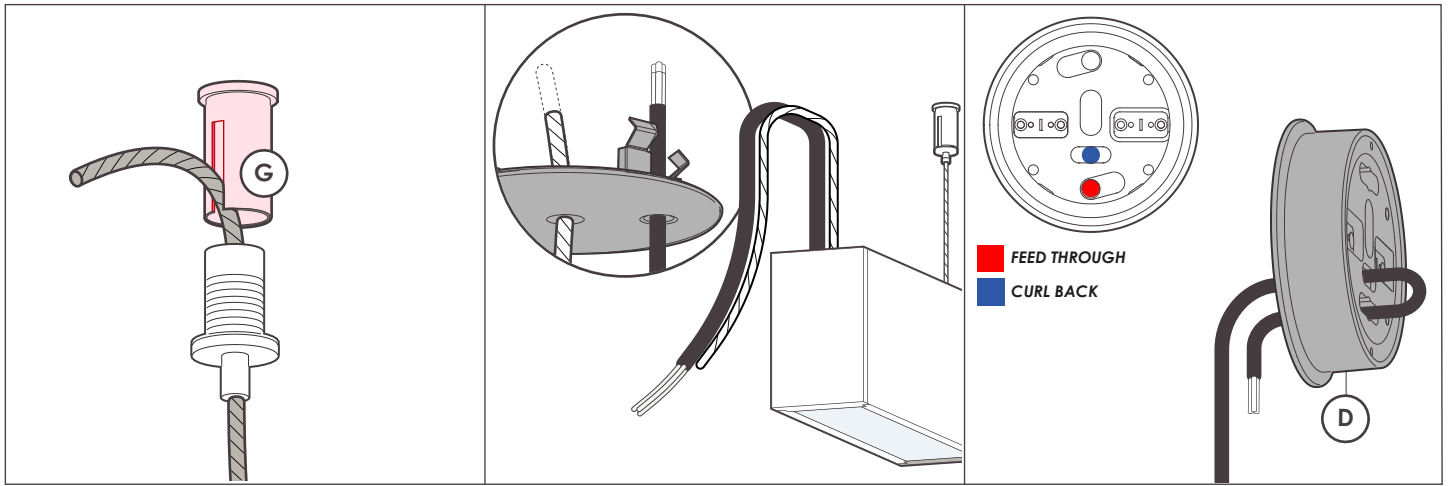

8.
Insert excess Wire(I) through slot & connect Gripper(H) & Posilock(G).

9.
Pull supplied Suspension Wire through centre hole in Ceiling Plate Cover(E). Pull power cable through second hole.

10. IF SM CEILING PLATE A
Thread power cable (from fitting) through cable anchor of Ceiling Plate(D). Curl back into cutout.

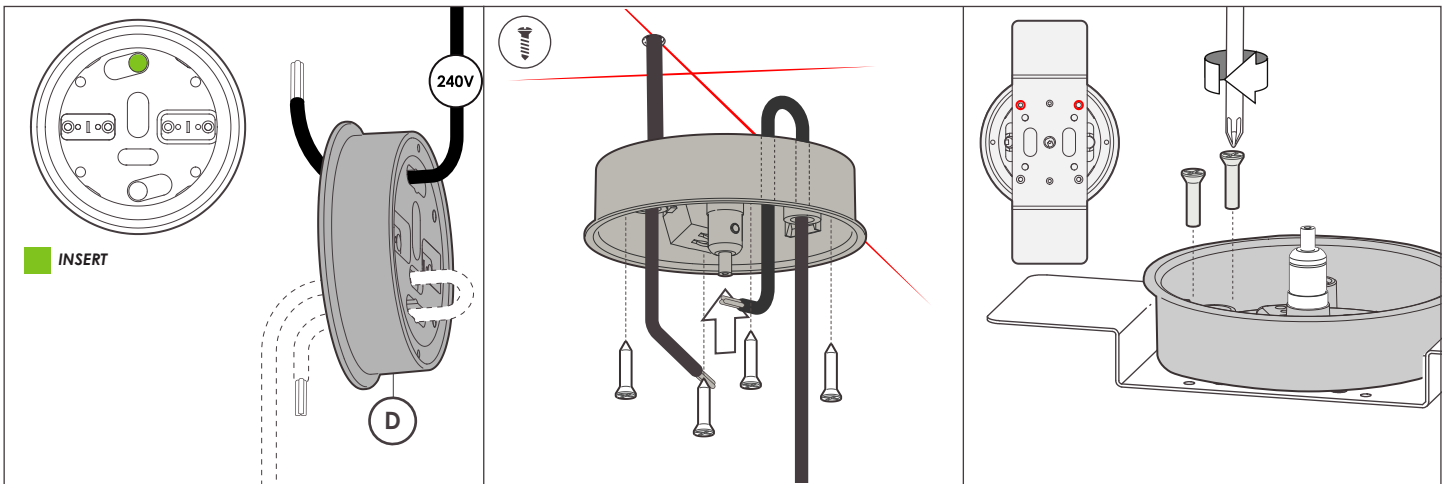

IF SM CEILING PLATE B
Insert power cable (from ceiling) through opposite cutout (see inset).

IF SM CEILING PLATE C
Fix Ceiling Plate(D) with appropriate fasteners (not supplied).

10. IF REC CEILING PLATE A
Align Ceiling Plate(D) holes and install 2 of 4 bolts into one side of Bracket(F).

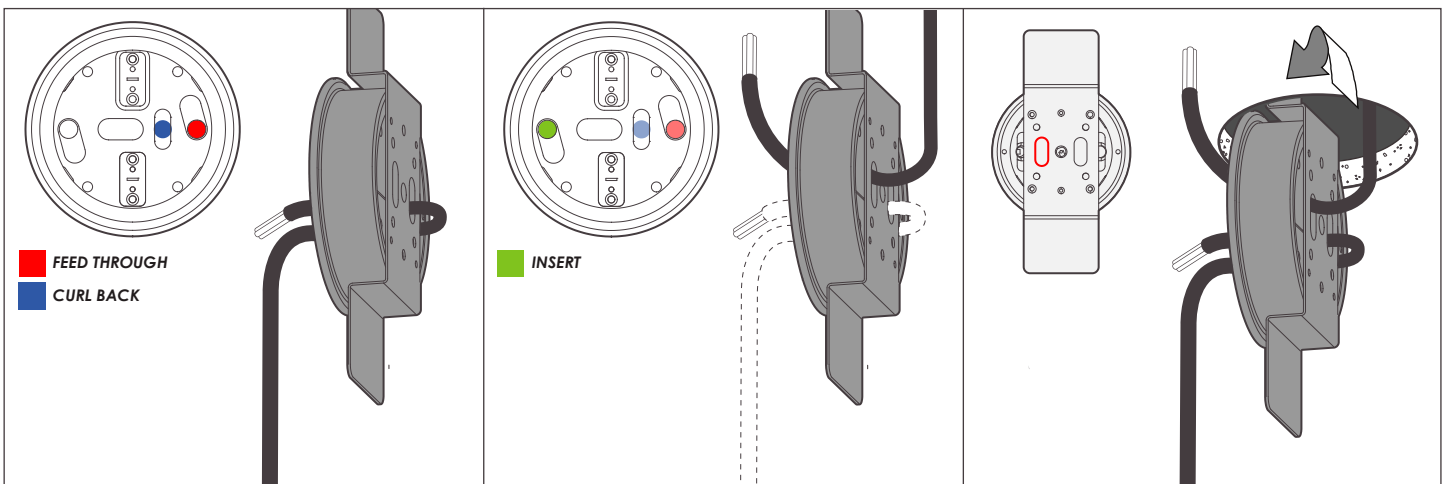

IF REC CEILING PLATE B
Thread power cable (from fitting) through cable anchor & Bracket(F). Curl back into cutout.

IF REC CEILING PLATE C
Insert power cable (from ceiling) through opposite cutout (see inset).

IF REC CEILING PLATE D
Insert the fixed Ceiling Plate(D) & Bracket(F) into the cutout. Ensure lip of ceiling plate sits proud of surface.

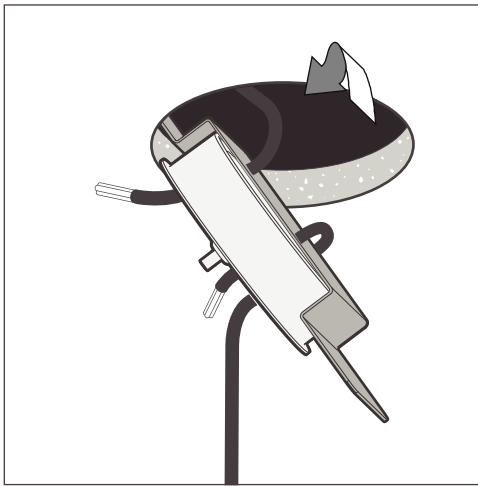

IF REC CEILING PLATE E

Step the fixed Ceiling Plate(D) & Bracket(F) into the cutout.

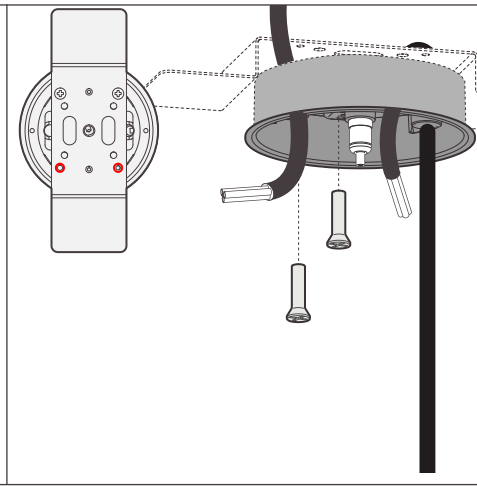

IF REC CEILING PLATE F

Fix the remaining side of the Ceiling plate(D) into Bracket(F) with the remaining 2 bolts.

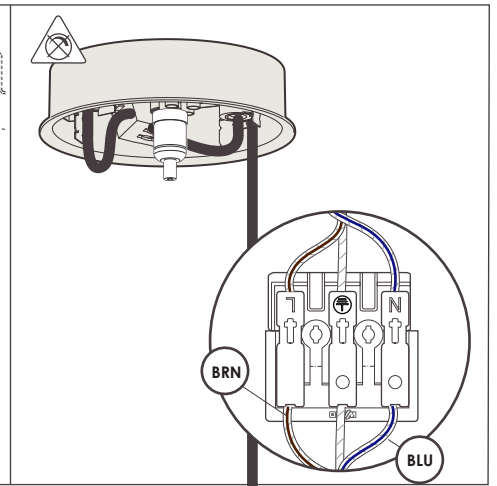

IIA. IF NON DIM

Insert wires into terminal.

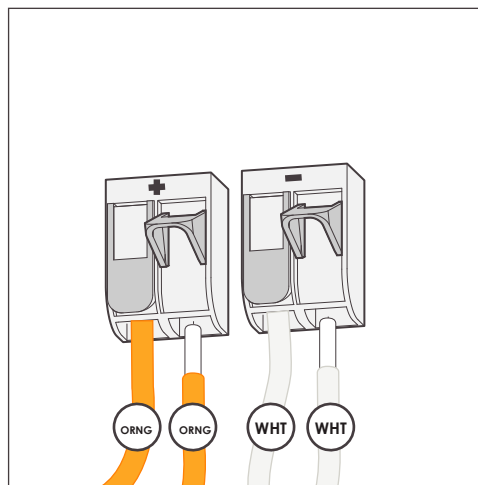

IIB. IF DIM

Repeat previous steps by inserting wires into terminal. Connect dimming wires to Wago plugs.

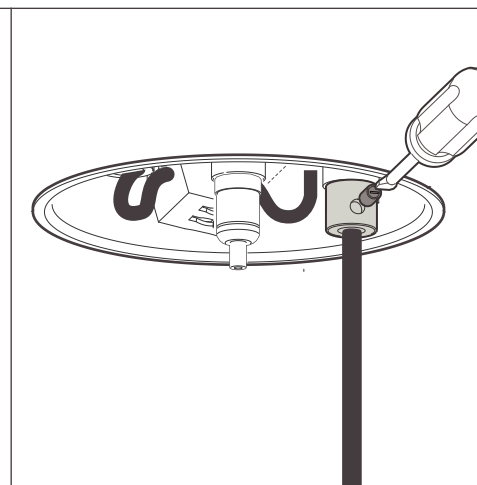

12.

Fix 3mm grub screw into cable anchor with flathead driver.

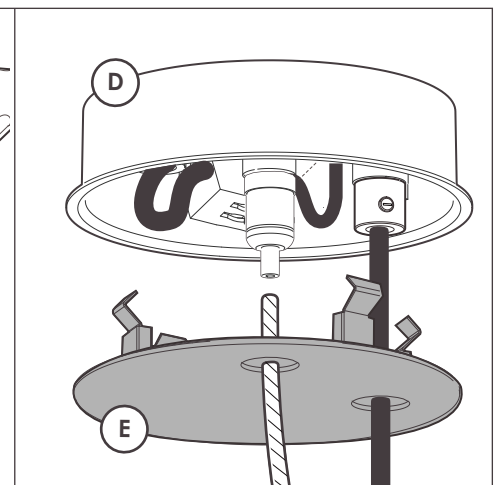

13.

Attach Cover(E) onto the Ceiling Plate(D). Insert suspension wire into Posilock.

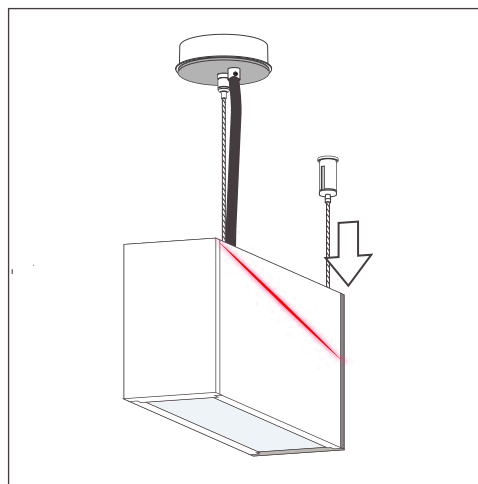

14.

Use Laser Plum to ensure fitting is straight.

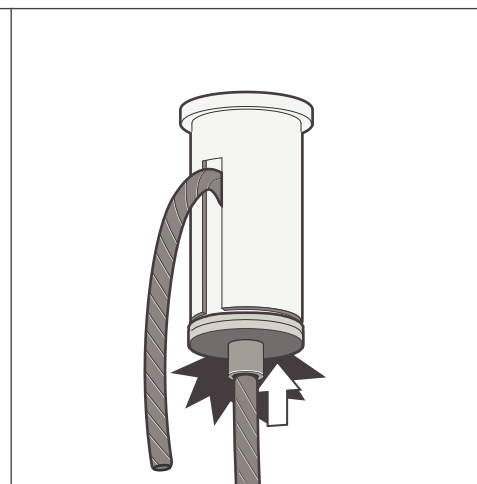

15. IF ADJUSTMENT IS REQ.

Press sprung tip of Wire Gripper(H). Adjust length of wire until all suspension points are level.

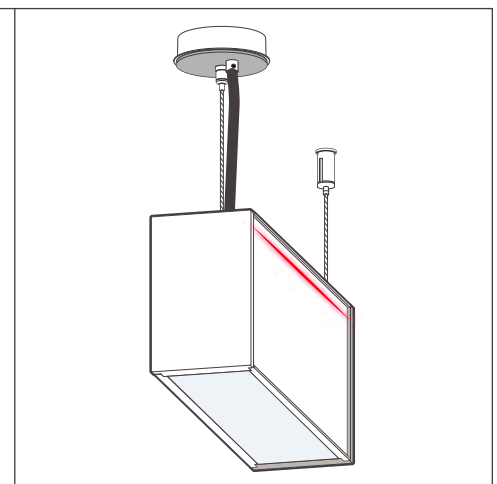

16.

Use laser to confirm bodies are square and levelled correctly.

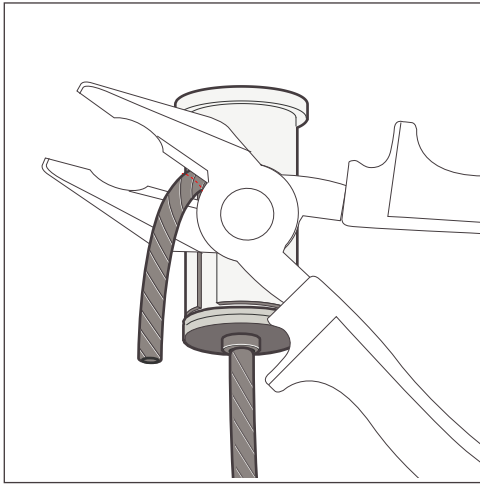

17.
Using pliers, trim off excess *Suspension Wire(I)*.

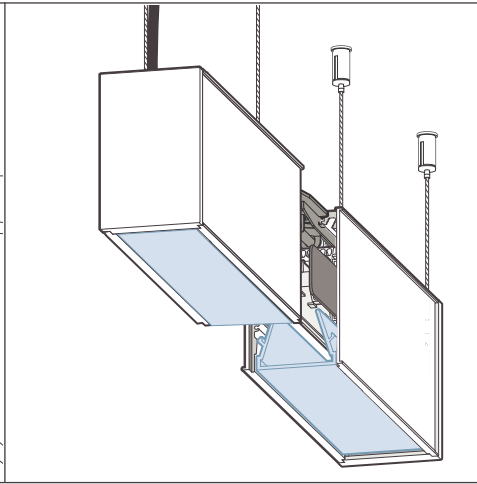

18. IF MULTIPLE BODIES.
Repeat stages 10-18 to install secondary fitting.

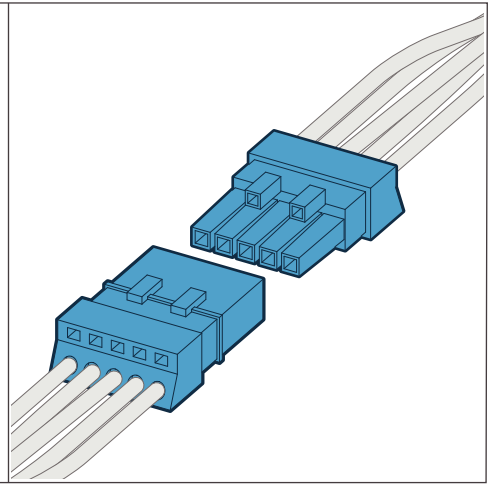

19.
Connect necessary plugs.

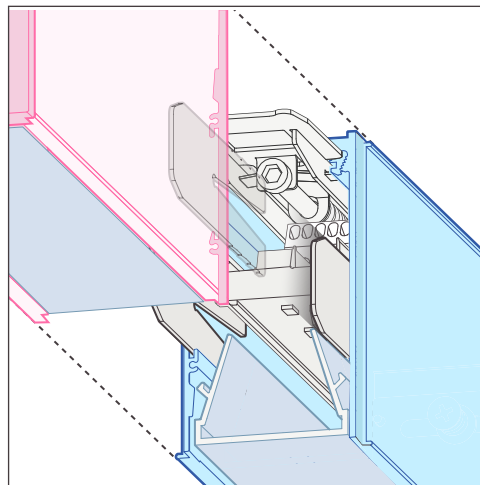

20.
Align *Linear Connector(M)* into sliding detail of start body. Push male 'END' body into female 'START' body.

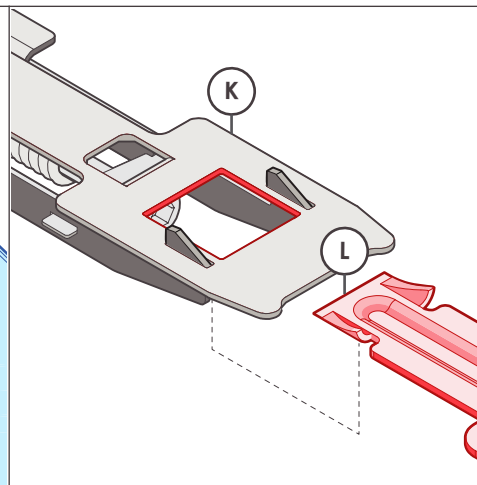

21.
Ensure *Key(L)* floats into catch.

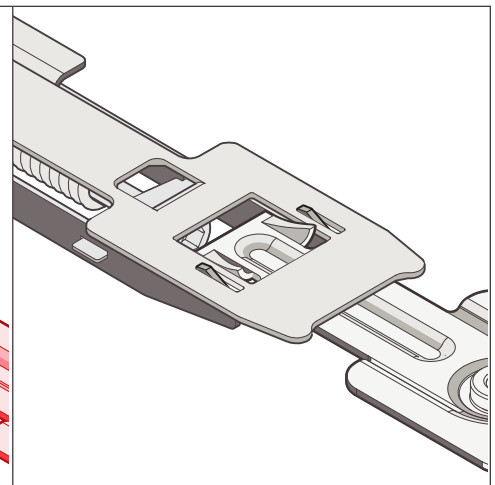

22.
Ensure spring releases and main bodies are tensioned together.

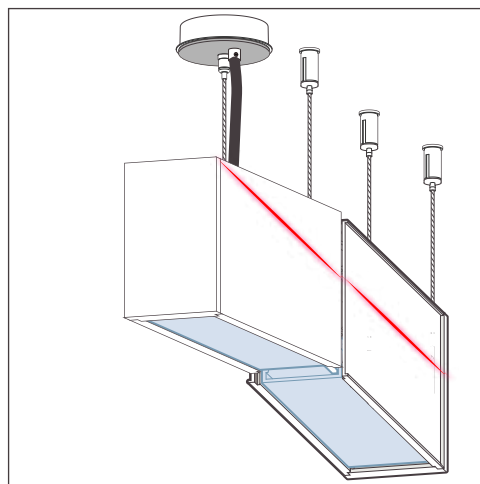

23.
Use Laser Plum to ensure fitting is straight.

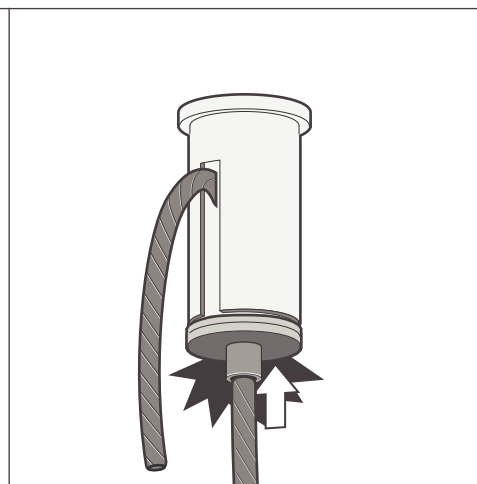

24. IF ADJUSTMENT IS REQ.
Press sprung tip of *Wire Gripper(H)*. Adjust length of wire until all suspension points are level.

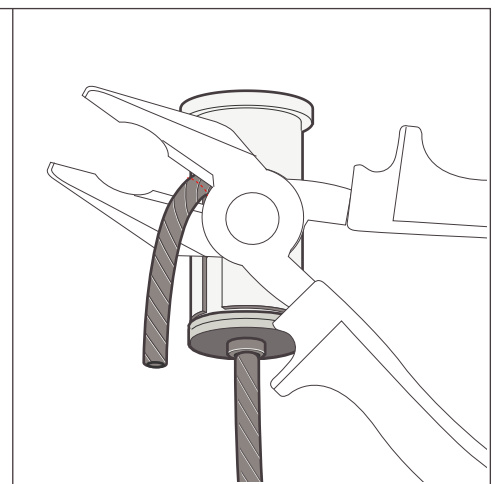

25.
Using pliers, trim off excess *Suspension Wire(I)*.