

SLIM C IP67

SURFACE MOUNTED PROFILE



Ensure that products are mounted with supplied, recommended or appropriate screws and fixings to suit the mounting surface.

WARNING

INSTALLATION IS ONLY TO BE CARRIED OUT BY SUITABLY QUALIFIED PERSONS IN ACCORDANCE WITH INSTALLATION INSTRUCTIONS AND ALL APPLICABLE REGULATIONS OR STANDARDS. (IMPROPER INSTALLATION CAN CREATE AN ELECTRICAL HAZARD WITH RISK OF ELECTRIC SHOCK, FIRE OR INJURY). DARKON WILL NOT BE HELD RESPONSIBLE FOR ANY CONSEQUENCES ARISING FROM IMPROPER PRODUCT HANDLING, STORAGE OR INSTALLATION.

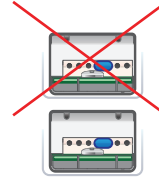

FOR OPTIMAL LONGEVITY, ENSURE UNRESTRICTED AIRFLOW OVER LUMINAIRE & REMOTE DRIVER.
DO NOT COVER LUMINAIRE OR DRIVER WITH INSULATION. DO NOT STACK DRIVERS.

68

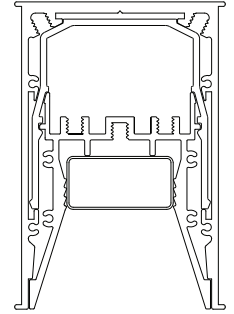

46

TOOLS REQUIRED

POWER DRILL / DRILL BIT / PHILLIPS DRIVER / PENCIL / PLIERS / TAPE MEASURE / PLUM LASER

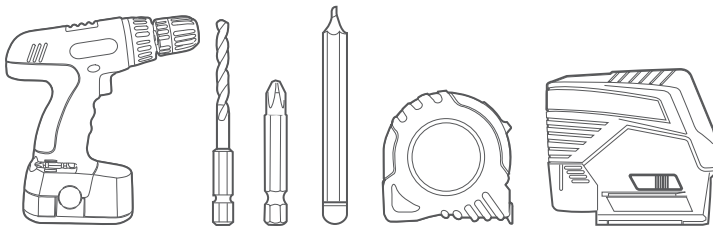

MAINTENANCE



Wipe product with a clean dry microfiber cloth.

SERVICING

'Remote driver' can be replaced if deemed faulty

NOTE:

- Component quantity indicative of single body fittings only, multibody fittings require multiples.
- **Linear connector only necessary if installing multiple body luminaires.

COMPONENTS



DISTANCE

DESCRIPTION

A)	45MM	POWERFEED DIMENSION
B)	150MM	MOUNTING LOCATION
C)	PROFILE LENGTH ÷ 2	3RD MOUNTING LOCATION (IF LENGTH IS GREATER THAN 2.2M)

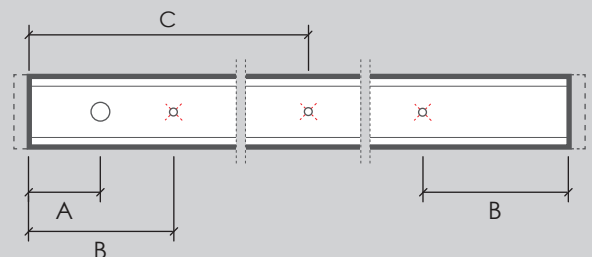
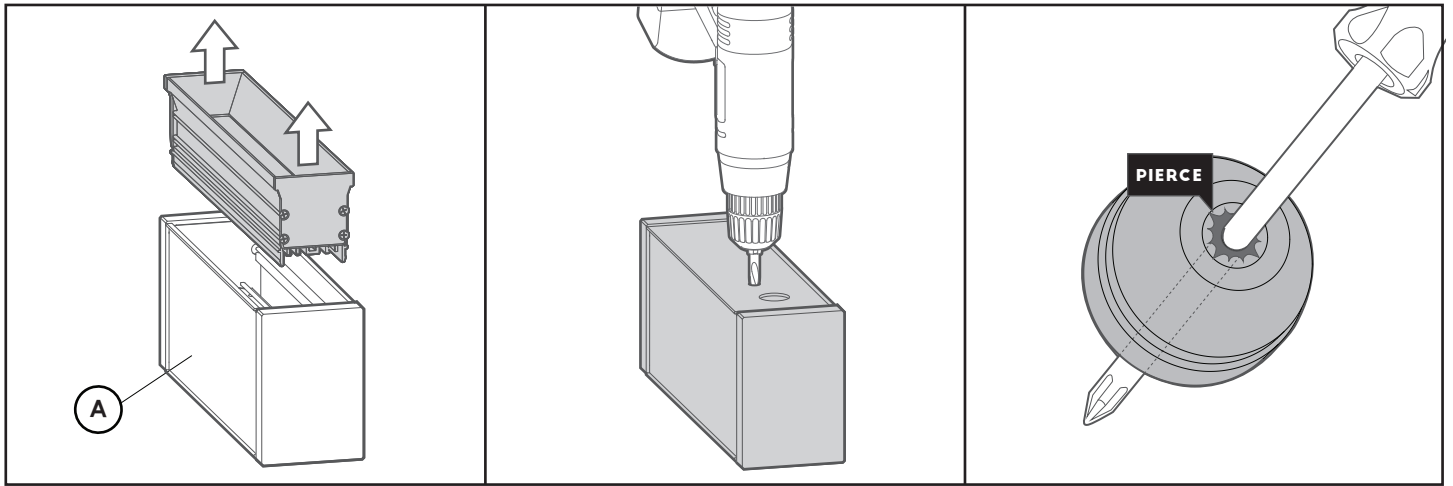

FIGURE 1. CRITICAL DIMENSIONS





1. Remove light tray(B) out of mainbody(A).

2. Mark & drill through the profile on locations shown. Central hole is only necessary for fittings exceeding 2,200mm in length.

3. Pierce IP rated grommet(C) with tip of screw driver.

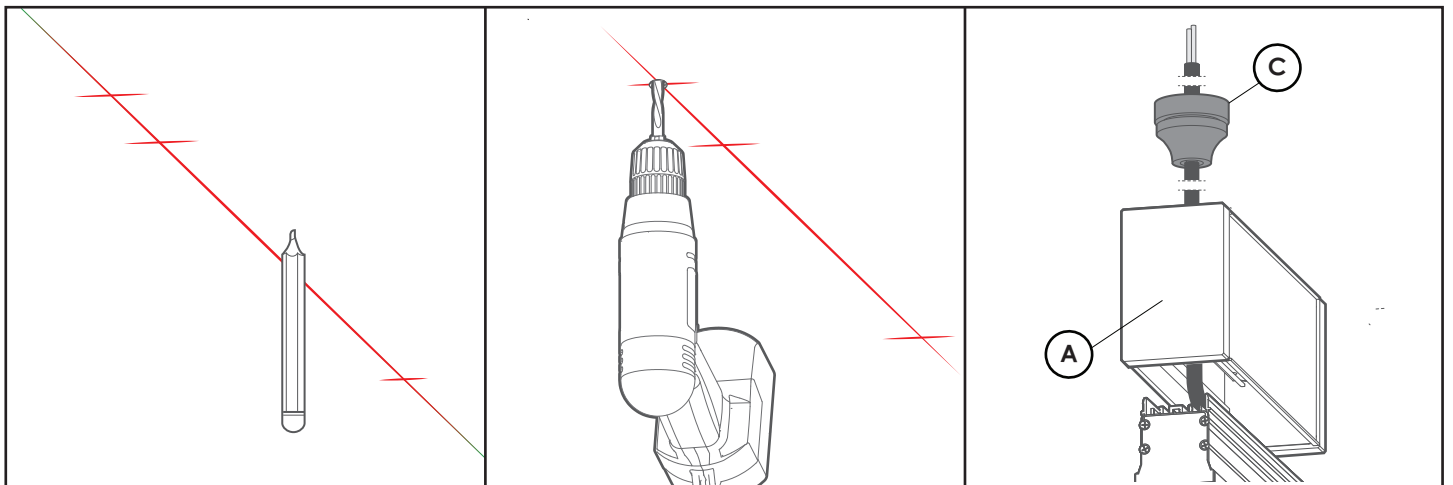

4. Mark where the luminaire is to be installed.

5. Drill all necessary holes with an appropriate drill bit.

6. Feed power cable through mainbody(A) and IP rated grommet(C).

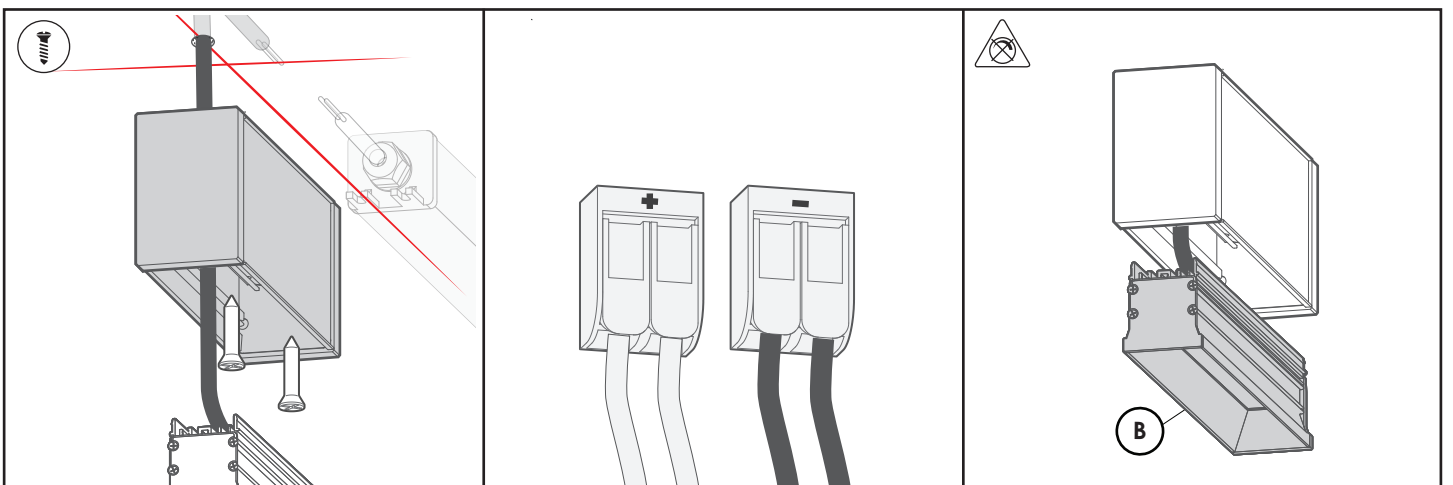

7. Feed cable through ceiling.
Fix mainbody(A) with appropriate mounting screws(D) to ceiling (screws not supplied).

8. Connect necessary plugs.

9. Install light trays(B) by snap fitting into clips(E). Centre light tray.

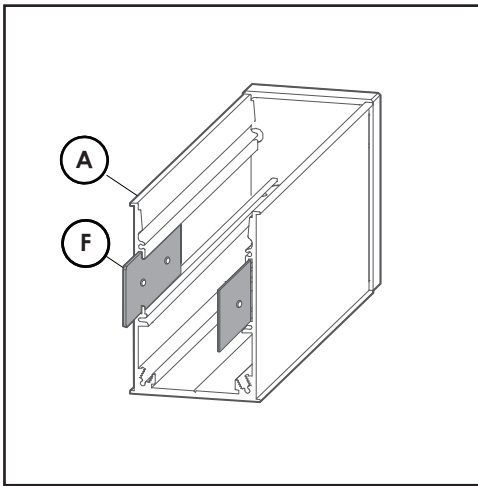

10. IF MULTIPLE BODIES
Slide linear connectors(F) in sliding detail of mainbody(A).

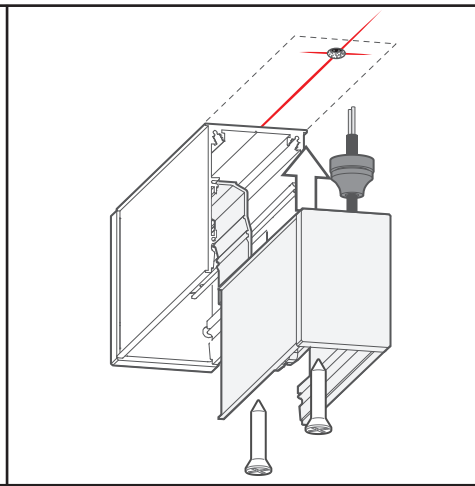

11.
Replicate stages 3-7 in installing other main bodies(A) with appropriate fixings

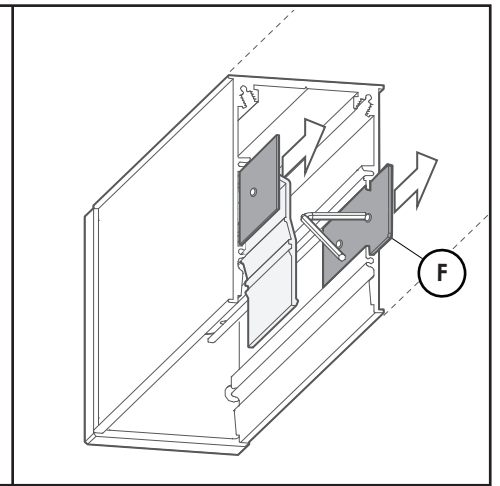

12.
Slide Linear connector(F) inbetween bodies. Fasten all grub screws to fix multiple bodies together.

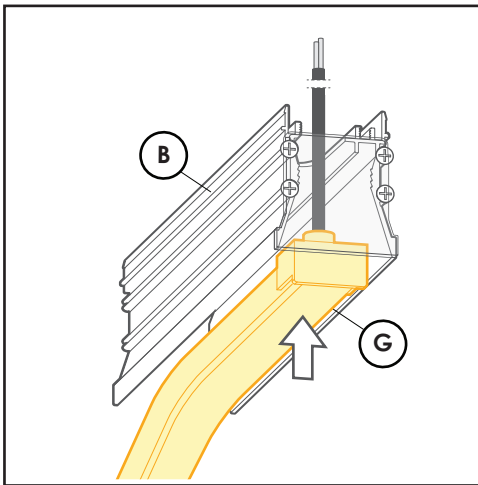

13.
Feed power cable through cutout of Gear Tray(B).

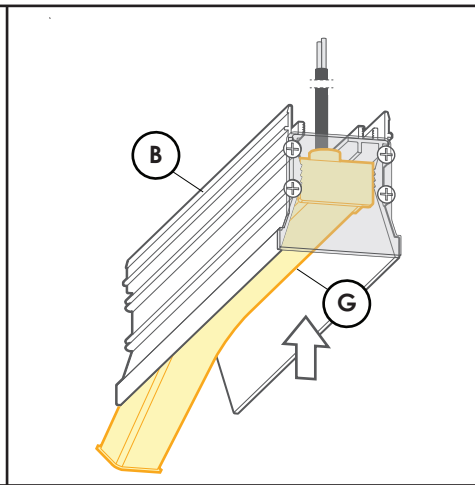

14.
Seat Flexible LED(G) into start Gear Tray(B) by pressing into 'tooth' detail of Gear Tray. Press hard up against endcap.

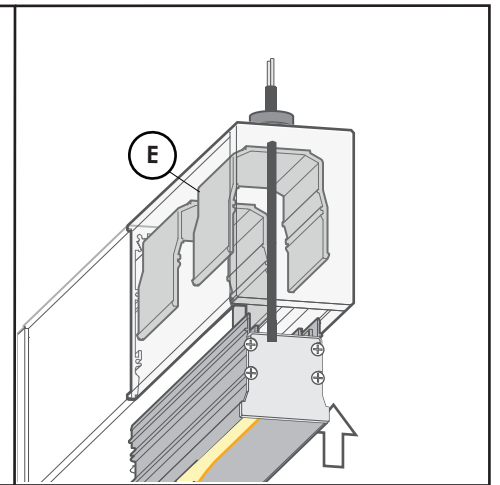

15.
Install Start Gear Tray (B) by snap fitting into clips(E)

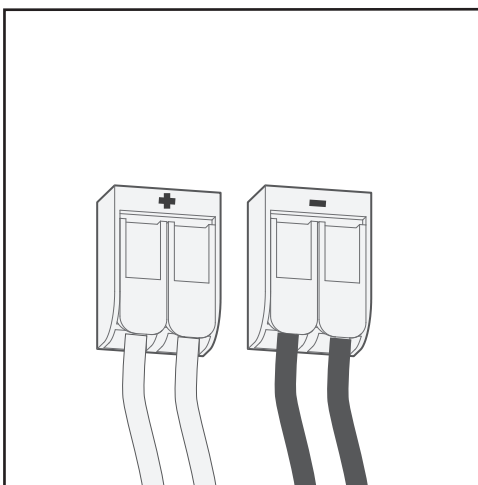

16.
Connect necessary plugs.

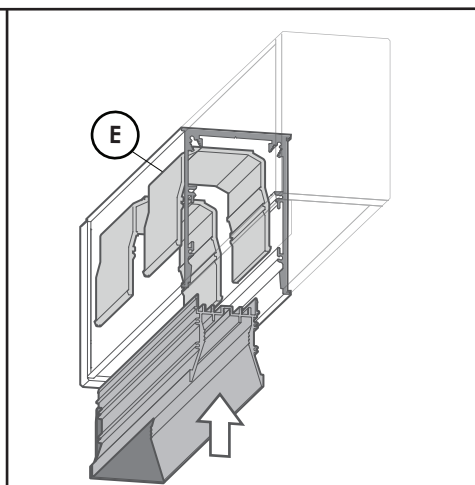

17.
Install 'End' Gear Tray by snap fitting into clips(E)

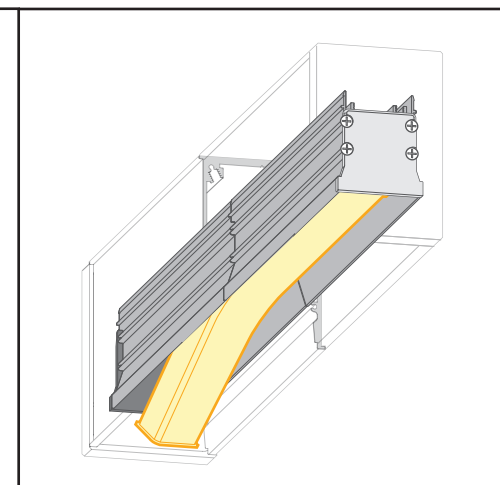

18.
Seat remainder of Flexible LED(G) into 'End' Gear Tray by pressing into 'tooth' detail of Gear Tray.