

Ensure that products are mounted with supplied, recommended or appropriate screws and fixings to suit the mounting surface.

## WARNING

INSTALLATION IS ONLY TO BE CARRIED OUT BY SUITABLY QUALIFIED PERSONS IN ACCORDANCE WITH INSTALLATION INSTRUCTIONS AND ALL APPLICABLE REGULATIONS OR STANDARDS. (IMPROPER INSTALLATION CAN CREATE AN ELECTRICAL HAZARD WITH RISK OF ELECTRIC SHOCK, FIRE OR INJURY). DARKON WILL NOT BE HELD RESPONSIBLE FOR ANY CONSEQUENCES ARISING FROM IMPROPER PRODUCT HANDLING, STORAGE OR INSTALLATION.

## TOOLS REQUIRED

POWER DRILL / DRILL BIT / PHILLIPS DRIVER / PENCIL / SCREWDRIVER / LENS REMOVAL TOOL

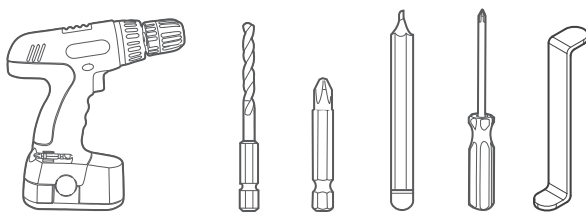

## COMPONENTS

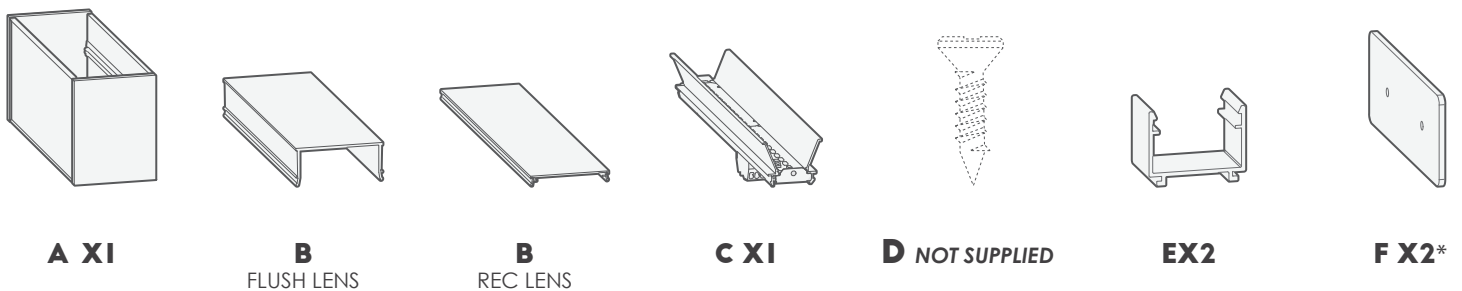

## NOTE:

- Component quantity indicative of single body fittings only, multibody fittings require multiples.
- \*\*Linear connector only necessary if installing multiple body fitting.
- Guide applicable for both Recessed and Flush lens Surface-mounted Mrs T.

DATUM	DISTANCE	DESCRIPTION
A)	45MM	POWERFEED
B)	150MM	MOUNT POINT
C)	PROFILE LENGTH/2	3RD MOUNT POINT IF GREATER THAN 2.2M

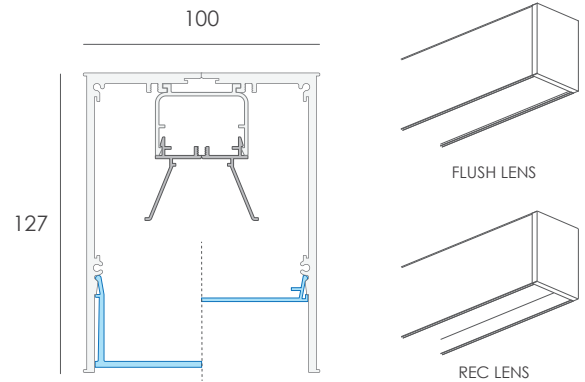

## MAINTENANCE



Wipe product with a clean dry microfiber cloth.  
Do not use any cleaning products/ chemicals to clean product.

## SERVICING

- Lens can be removed w/ lens removal tool.
- 'Light Tray 60 ' can be replaced if deemed faulty

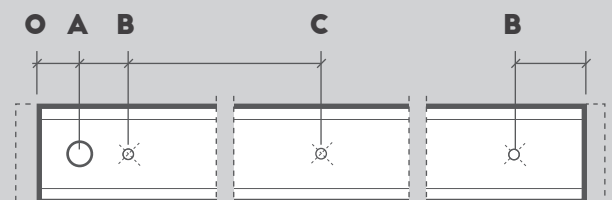
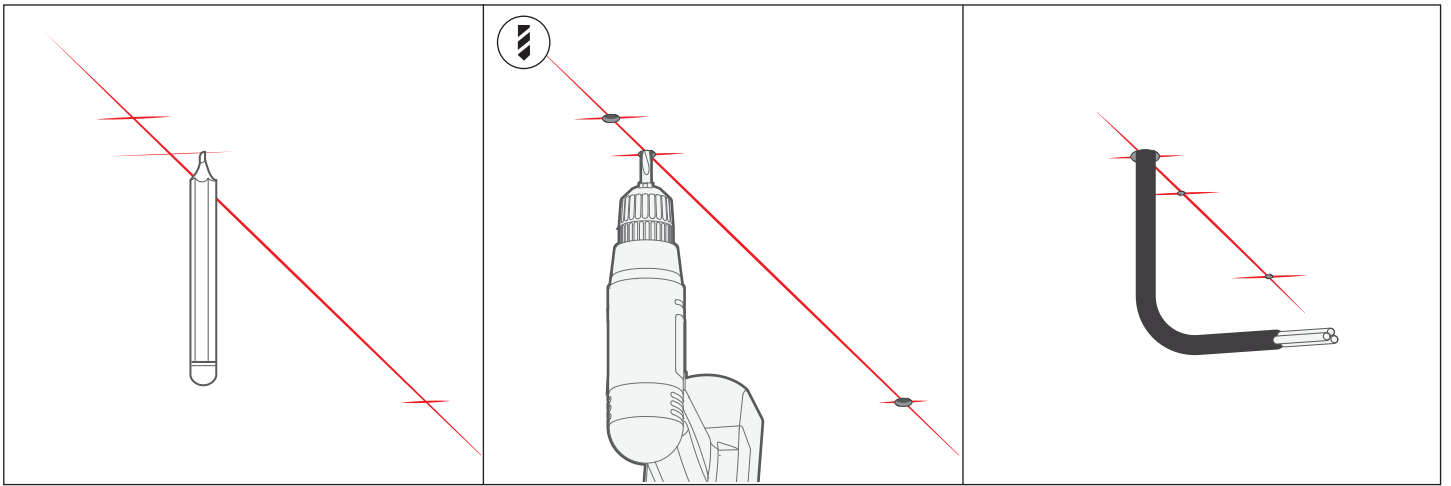

FIGURE A. CRITICAL DIMENSIONS



**1.**  
Measure and mark the appropriate placement of luminaire. Refer to **FIGURE A** for critical dimensions.

**2.**  
Drill all necessary holes with an appropriate drill bit.

**3.**  
Pull power cable through ceiling.

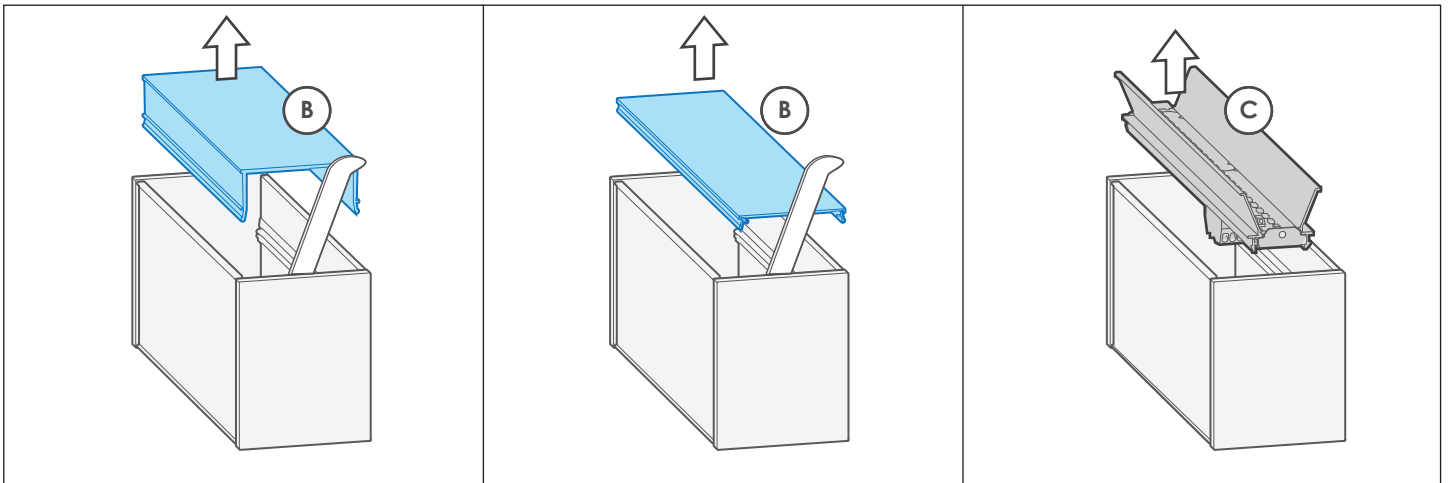

**4A. IF FLUSH LENS**  
Unassemble luminaire by removing Flush lens(B).

**4B. IF REC LENS**  
Unassemble luminaire by removing Flush lens(B).

**5.**  
Remove Light Tray(C) using a flat head screw driver to lever LT(C) out of retention clips(E).

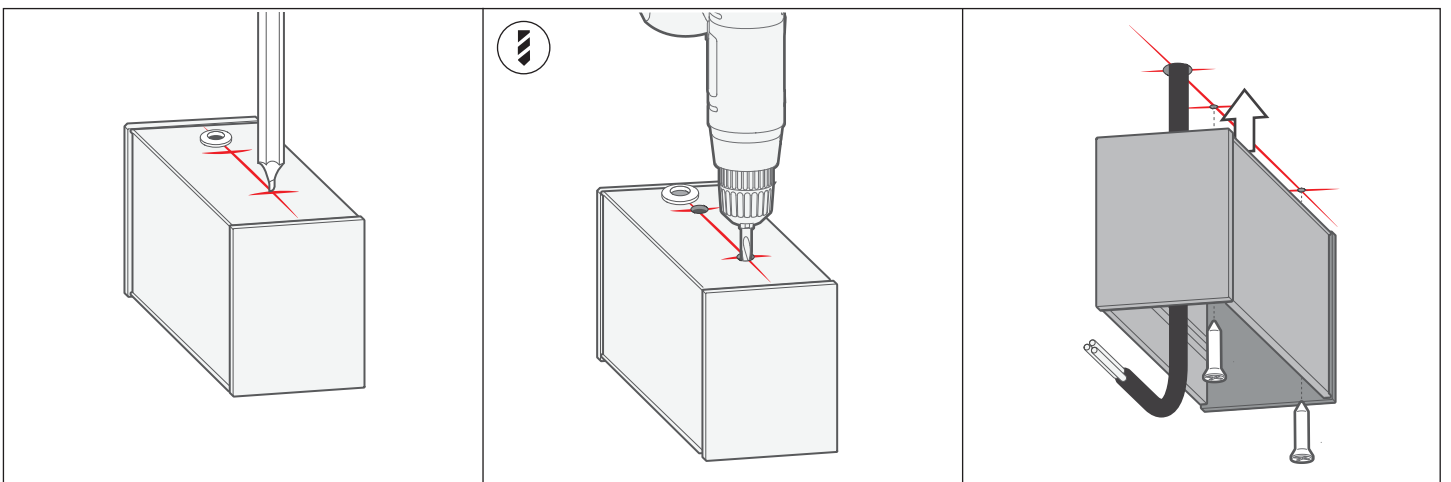

**6.**  
Mark mainbody(A) on locations shown in figure A. If length exceed 2.2m, mark third hole at centre.

**7.**  
Drill clearance holes at marked up locations to suit appropriate fasteners(D).

**8.**  
Feed the Power Cable through grommet & mainbody(A).

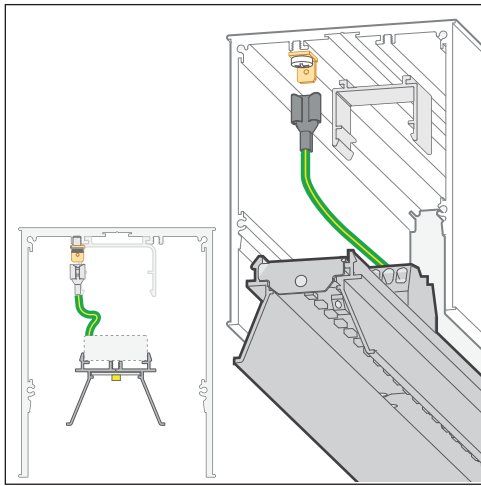

**9.**  
Insert Earth spade into Terminal on all bodies.

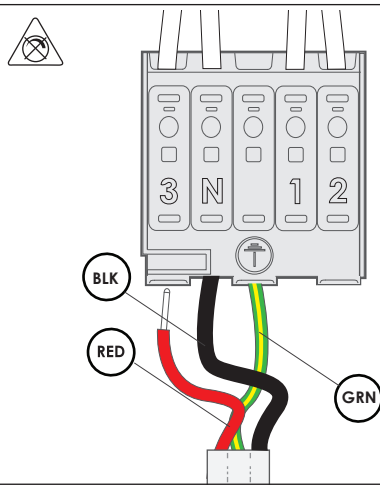

**10A. IF NON DIM**  
Wire primary wires into terminal.

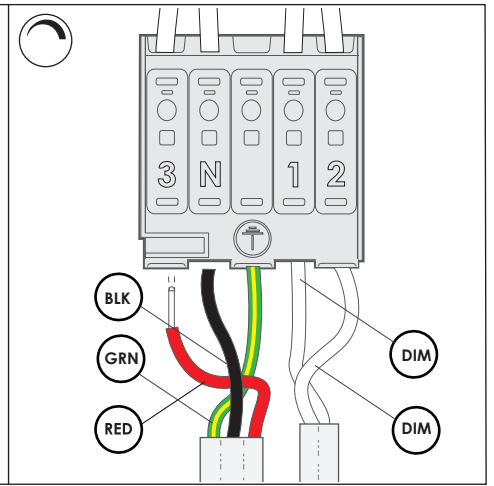

**10B. IF DIM**  
Wire primary wires into terminal.  
Wire Dimming wires into terminal.

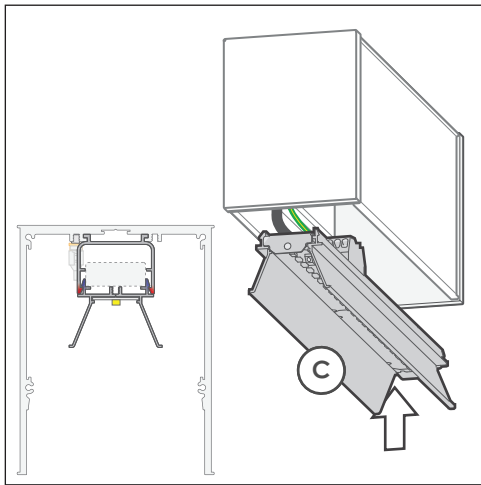

**11.**  
Install *light tray*(C) by snap fitting into *clips*(E). Centre light tray.

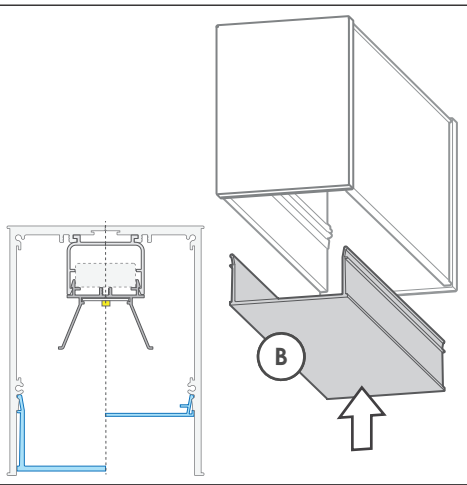

**12.**  
Install *Lens*(B) by snap fitting into clipping detail. Centre lens.

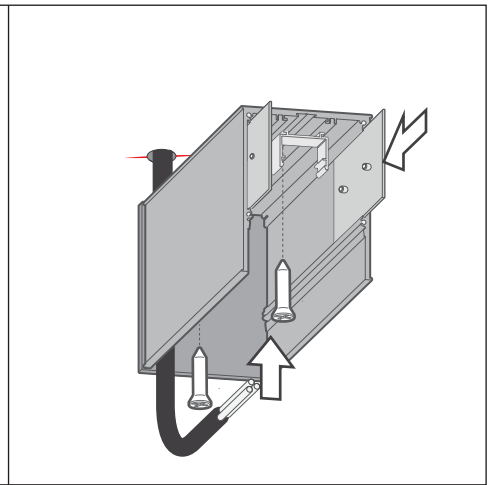

**13. IF MULTIPLE BODIES**  
Replicate stages in order to install first body.  
Ensure *linear connectors*(F) are located at join).

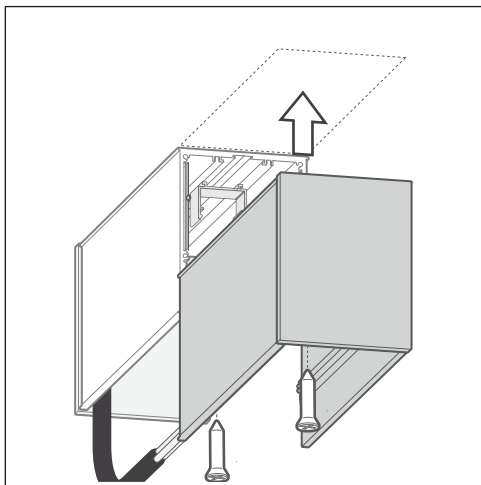

**14.**  
Replicate prior stages in order to install secondary body.

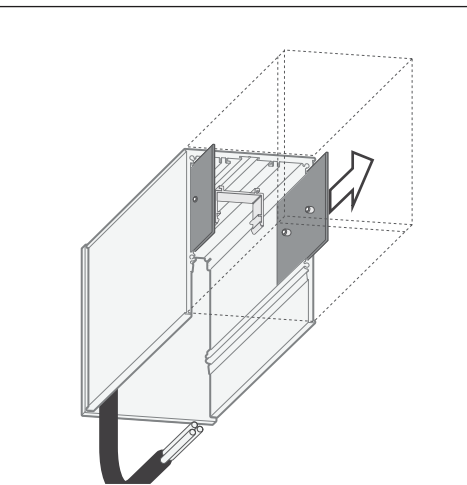

**15.**  
Ensure both bodies are butted up against each other. Slide linear Connector(F) between join.

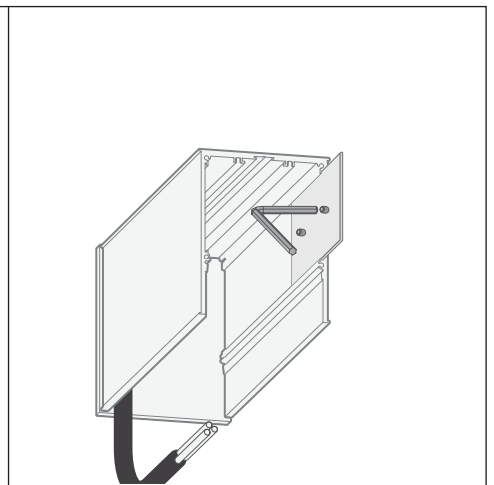

**16.**  
Fasten all grub screws to fix multiple bodies together.

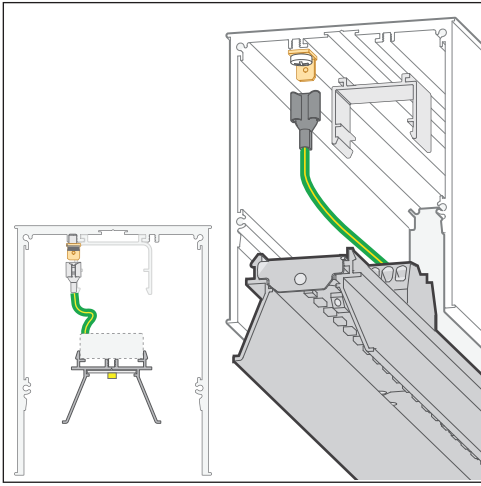

**17.**  
Insert Earth spade into Terminal on all bodies.

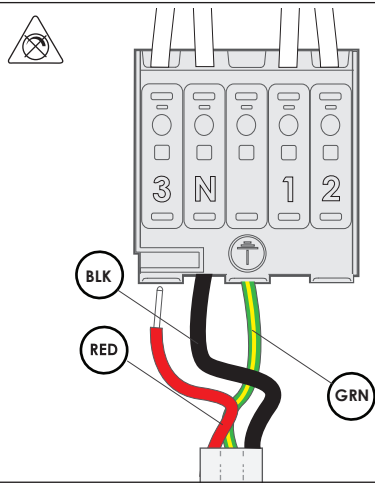

**18A. IF NON DIM**  
Wire primary wires into terminal.

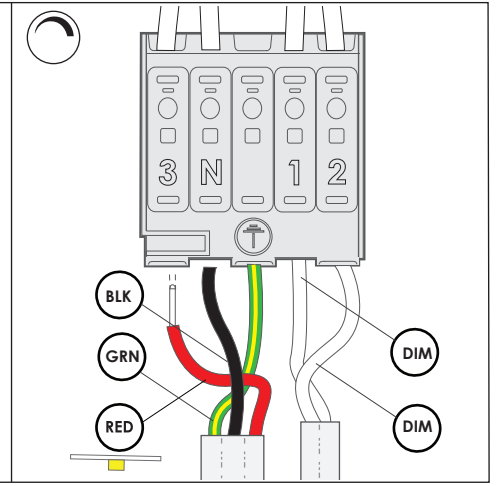

**18B. IF DIM**  
Wire primary wires into terminal.  
Wire Dimming wires into terminal.

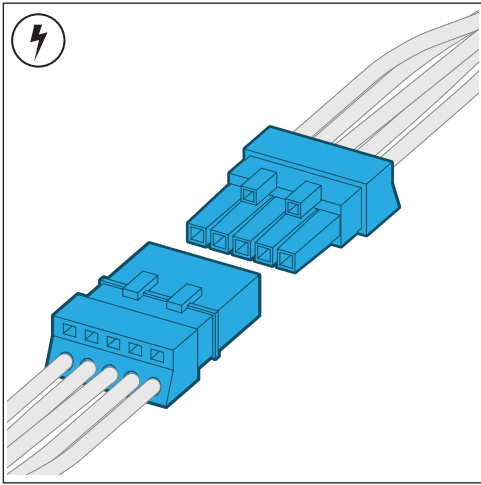

**19.**  
Connect the appropriate plugs.

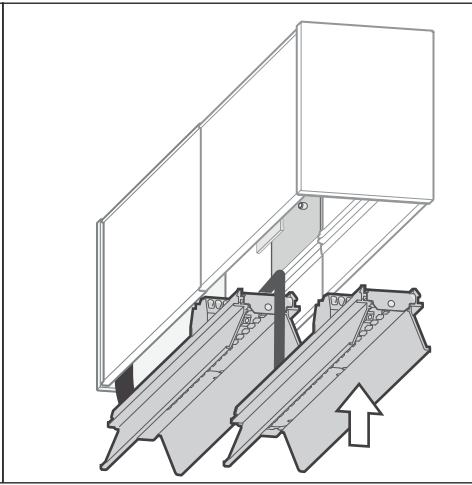

**20.**  
Install *light tray(C)* by snap fitting into *clips(E)*. Centre light tray.

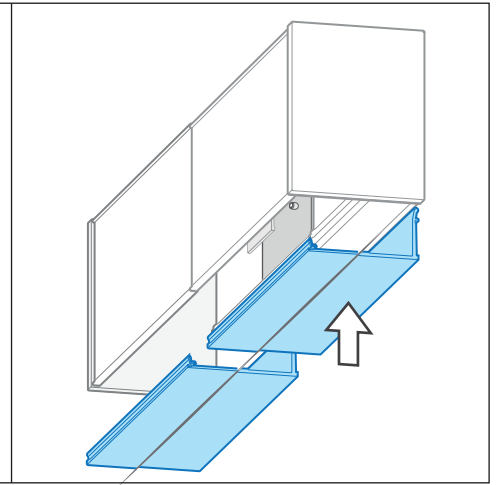

**21.**  
Install *Lens(B)* by snap fitting into clipping detail. Centre lens.